

- CONSTRUCTION NOTES:**
- 1 SANDBLAST EXISTING STRIPING AND OTHER PAVEMENT MARKINGS.
 - 2 INSTALL 12" IN WIDTH YELLOW CROSS WALK LINES PER CALTRANS STD. PLAN NO. A-24E.
 - 3 INSTALL TWO-WAY LEFT TURN LANES DETAIL 31 PER CALTRANS STD. PLAN NO. A-20B.
 - 4 INSTALL "INSTALLATION B" SCHOOL CROSSING SIGN (W66) AND SCHOOL XING PLATE (W66A).
 - 5 INSTALL "INSTALLATION C" SCHOOL PLATE (W65), SPEED LIMIT (R2) AND WHEN CHILDREN ARE PRESENT (R72) WITH POST MOUNTING FLASHING YELLOW BEACONS.
 - 6 INSTALL YELLOW "SLOW SCHOOL XING" PAVEMENT MARKINGS PER CALTRANS STD. PLAN NO. A-24D.
 - 7 INSTALL W11 AND R63 SIGN.
 - 8 INSTALL "END SCHOOL ZONE" SIGN (W65-1).
 - 9 INSTALL "STOP SIGN" SIGN (R-1).
 - 10 INSTALL "STOP" AND STOP LINE PER CALTRANS STD. PLAN NO. A-24D AND A-24E.
 - 11 INSTALL "INSTALLATION A" ADVANCE SCHOOL SYMBOL (W63) AND "SCHOOL" SIGN (W65).
 - 12 INSTALL CHANNELIZING LINE DETAIL 38A PER CALTRANS STD. PLAN NO. A-20D.
 - 13 INSTALL TYPE IV (L) ARROW PER CALTRANS STD. PLAN NO. A-24A.
 - 14 INSTALL TYPE VI ARROW PER CALTRANS STD. PLAN NO. A-24A.
 - 15 INSTALL MEDIAN ISLANDS DETAIL 28 PER CALTRANS STD. PLAN NO. A-20B.
 - 16 INSTALL LANES LINE DETAIL 8 PER CALTRANS STD. PLAN NO. A-20A.
 - 17 INSTALL EDGE LINES DETAIL 27B PER CALTRANS STD. PLAN NO. A-20B.
 - 18 INSTALL NO PASSING ZONE-TWO DIRECTIONS DETAIL 21 PER CALTRANS STD. PLAN NO. A-20A.
 - 19 INSTALL "LANE ENDS MERGE LEFT" W75 & W11 SIGN.

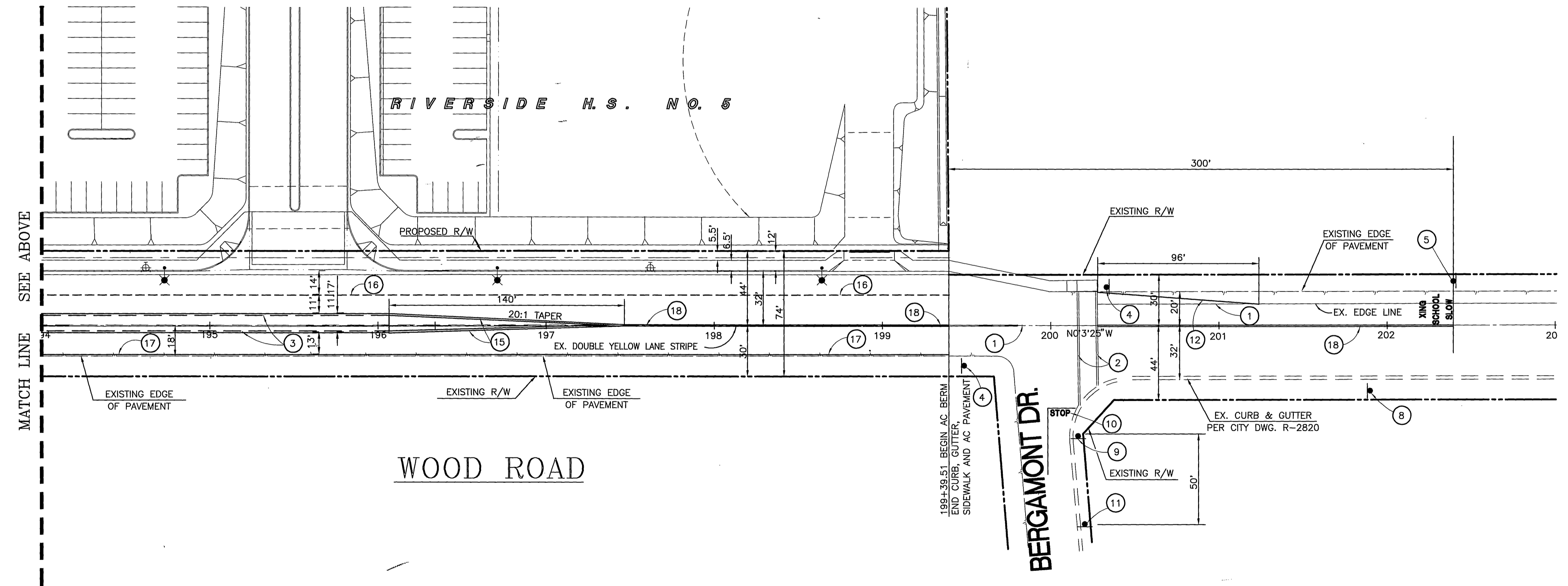

- GENERAL NOTES FOR TRAFFIC STRIPING PLAN AND SIGNING:**
1. TRAFFIC STRIPING, PAVEMENT MARKING LEGENDS AND RAISED PAVEMENT MARKERS SHALL BE PER CALTRANS STANDARD PLANS AND STANDARD SPECIFICATIONS SECTION 84 AND 85, JANUARY, 1992.
 2. ALL STRIPING, SIGNS, AND LEGENDS SHALL BE REFLECTORIZED. PAVEMENT LEGENDS AND MARKINGS SHALL MATCH CITY STENCILS. ALL DETAILS REFER TO CALTRANS STANDARD PLANS A-20A THROUGH A-20D AND A-24A THROUGH A-24D.
 3. ALL CONFLICTING LINES, MARKINGS AND RAISED PAVEMENT MARKERS SHALL BE REMOVED BY WET SANDBLASTING OR METHOD APPROVED BY THE CITY ENGINEER.
 4. ALL REMOVED SIGNS IN GOOD CONDITION SHALL BE SALVAGED AND DELIVERED TO THE CITY YARD.
 5. ALL SIGNS TO BE REFLECTORIZED AND PER CITY STANDARD.
 6. ALL STRIPING SHOWN INCLUDES RAISED PAVEMENT MARKERS PER APPLICABLE CALTRANS DETAILS.
 7. THE CONTRACTOR SHALL OBTAIN APPROVAL FROM THE CITY ENGINEER FOR ON-SITE LAYOUT (CAT-TRACKING) PRIOR TO FINAL STRIPE.
 8. ALL STRIPING AND MARKINGS SHALL BE THERMOPLASTIC AS PER CITY STANDARD SPECIFICATION.
 9. ALL SCHOOL AREA SIGNS SHALL BE REFERRED TO CALTRANS TRAFFIC MANUAL CHAPTER 10 SCHOOL AREA PEDESTRIAN SAFETY.

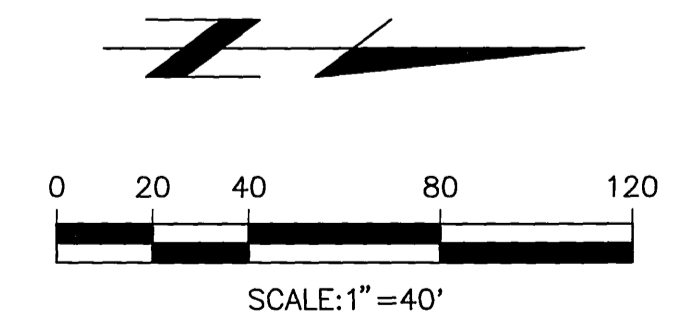

Underground Service Alert
 Call: TOLL FREE
1-800-227-2600
 TWO WORKING DAYS BEFORE YOU DIG

IMPORTANT NOTICE
 SECTION 4718/4213 OF THE GOVERNMENT CODE REQUIRES A DIG ALERT IDENTIFICATION NUMBER BE ISSUED BEFORE A "PROMPT TO EXCAVATE" WILL BE WILD FOR YOUR DIG ALERT ID NUMBER CALL UNDERGROUND SERVICE ALERT TOLL FREE 1-800-227-2600 TWO WORKING DAYS BEFORE YOU DIG

PRIVATE ENGINEERING NOTE
 CONSTRUCTION CONTRACTOR AGREES THAT IN ACCORDANCE WITH GENERALLY ACCEPTED CONSTRUCTION PRACTICES, CONSTRUCTION CONTRACTOR WILL BE REQUIRED TO ASSUME SOLE AND COMPLETE RESPONSIBILITY FOR JOB SITE CONDITIONS DURING THE COURSE OF CONSTRUCTION OF THE PROJECT, INCLUDING SAFETY OF ALL PERSONS AND PROPERTY; THAT THIS REQUIREMENT SHALL BE MADE TO APPLY CONTINUOUSLY AND NOT BE LIMITED TO NORMAL WORKING HOURS, AND CONSTRUCTION CONTRACTOR FURTHER AGREES TO DEFEND, INDEMNIFY AND HOLD DESIGN PROFESSIONAL HARMLESS FROM ANY AND ALL LIABILITY, REAL OR ALLEGED, IN CONNECTION WITH THE PERFORMANCE OF WORK ON THIS PROJECT, EXCEPTING LIABILITY ARISING FROM THE SOLE NEGLIGENCE OF DESIGN PROFESSIONAL.

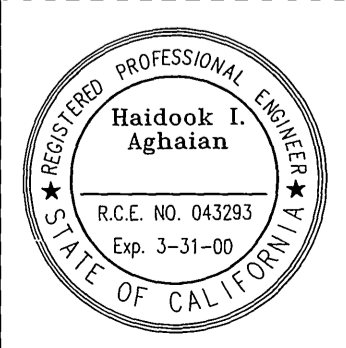

PREPARED UNDER THE DIRECTION OF:
Haidook I. Aghaian 6/30/97
 HAIDOOK I. AGHAIAN DATE
 R.C.E. 043293 - EXP. 3/31/00

BUSINESS TAX CERTIFICATION # 041318 EXP. DATE 8/27/97

THIENES ENGINEERING
 CIVIL ENGINEERING • LAND SURVEYING
 16800 VALLERVIEW AVENUE
 LA MIRADA, CALIFORNIA 90639
 (714) 521-4811

BENCHMARK: BM - P.K. NAIL & TAG E'LY SIDE OF TRAUTWEN ROAD, 100'± N'LY OF VAN BUREN BOULEVARD, N'LY WALL OF CATCH BASIN, 2' E'LY OF CURB FACE IN S/W. ELEV=1674.985 ADJ.

MARK	REVISIONS	APPR.	DATE

DESIGNED BY CMR DRAWN BY HL CHECKED BY HIA

CITY OF RIVERSIDE, CALIFORNIA
DEPARTMENT OF PUBLIC WORKS

APPROVED BY: [Signature] DATE: 7/1/97
 PRINCIPAL ENGINEER
 PARK DEPARTMENT
 TRAFFIC DIVISION
 DEPUTY P.W. DIRECTOR [Signature] DATE: 7/1/97

STRIPING AND SIGNING PLAN
 WESTERLY SIDE OF WOOD ROAD
 FROM BERGAMONT DR.
 SOUTHERLY 1400'

PROJECT NO.
XL-398
C 4.4
 SHEET 1 OF 1