

PAVEMENT DELINEATION LEGEND (BY CITY FORCES)

- (A) PAINT 4" SKIP WHITE STRIPE (7' STRIPE, 17" GAP)
- (B) PAINT 4" SOLID WHITE STRIPE (50')
- (C) PAINT 8" SOLID WHITE STRIPE
- (D) PAINT 4" SOLID DOUBLE YELLOW STRIPE
- (E) PAINT 12" SOLID WHITE MARKING
- (I) PAINT SOLID WHITE ARROW MARKING

*NOTE: REMOVE ANY CONFLICTING STRIPING AND PAVEMENT MARKINGS

	<p style="text-align: center;">CITY OF RIVERSIDE, CALIFORNIA DEPARTMENT OF PUBLIC WORKS</p> <table border="1" style="width: 100%; border-collapse: collapse;"> <tr> <td>APPROVED BY</td> <td>BY</td> <td>DATE</td> <td>APPROVED BY</td> </tr> <tr> <td>PRINCIPAL ENGINEER</td> <td></td> <td></td> <td>DIRECTOR OF PUBLIC WORKS</td> </tr> <tr> <td>P.W. INSPECTION</td> <td></td> <td></td> <td></td> </tr> <tr> <td>TRAFFIC DIVISION</td> <td>CS</td> <td>8/7/97</td> <td></td> </tr> <tr> <td>CHIEF P.W. ENGR.</td> <td></td> <td></td> <td>DATE</td> </tr> <tr> <td>PUBLIC UTILITIES</td> <td></td> <td></td> <td></td> </tr> </table>	APPROVED BY	BY	DATE	APPROVED BY	PRINCIPAL ENGINEER			DIRECTOR OF PUBLIC WORKS	P.W. INSPECTION				TRAFFIC DIVISION	CS	8/7/97		CHIEF P.W. ENGR.			DATE	PUBLIC UTILITIES				<p style="text-align: center;">REHAB. OF ARTERIAL STREETS 96-97</p> <p style="text-align: center;">JURUPA AVENUE PALM AVENUE TO RIVERSIDE AVENUE</p> <p style="text-align: center;">SCALE: 1" = 40'</p>	<p>ACCT. NO. 430-541500-440301-3003B</p> <p style="font-size: 1.2em;">XL-401-1</p> <p>(R-3470)</p> <p>SHEET 1 OF 2</p> <p>FILE NAME: XL401-1.DWG</p>
APPROVED BY	BY	DATE	APPROVED BY																								
PRINCIPAL ENGINEER			DIRECTOR OF PUBLIC WORKS																								
P.W. INSPECTION																											
TRAFFIC DIVISION	CS	8/7/97																									
CHIEF P.W. ENGR.			DATE																								
PUBLIC UTILITIES																											

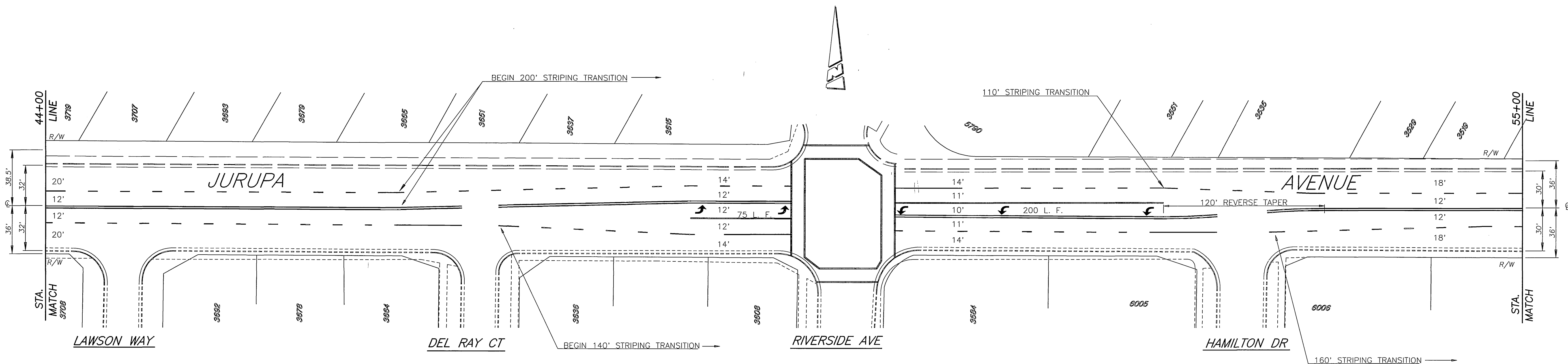
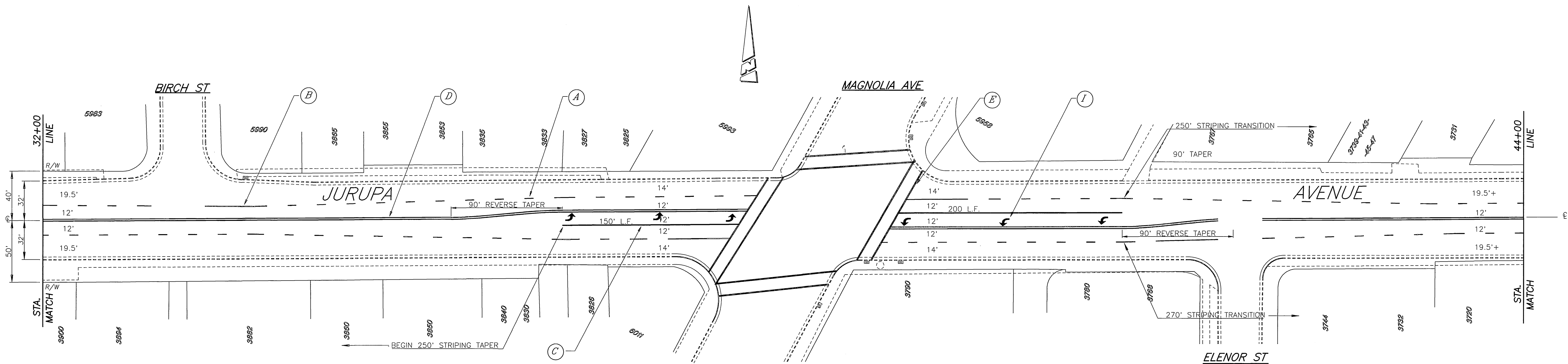

PAVEMENT DELINEATION LEGEND (BY CITY FORCES)

- (A) PAINT 4" SKIP WHITE STRIPE (7' STRIPE, 17" GAP)
- (B) PAINT 4" SOLID WHITE STRIPE (50')
- (C) PAINT 8" SOLID WHITE STRIPE
- (D) PAINT 4" SOLID DOUBLE YELLOW STRIPE
- (E) PAINT 12" SOLID WHITE MARKING
- (I) PAINT SOLID WHITE ARROW MARKING

*NOTE: REMOVE ANY CONFLICTING STRIPING AND PAVEMENT MARKINGS

ENGINEER IN RESPONSIBLE CHARGE
 FRANCIS R. DUNAJSKI
 T.R. No. 1569 expires 6/30/99
 DATE 8/7/97

CITY OF RIVERSIDE, CALIFORNIA DEPARTMENT OF PUBLIC WORKS			
APPROVED BY	BY	DATE	APPROVED BY
PRINCIPAL ENGINEER			DIRECTOR OF PUBLIC WORKS
P.W. INSPECTION			
TRAFFIC DIVISION		8/7/97	
CHIEF P.W. ENGR.			
PUBLIC UTILITIES			
MARK	REVISIONS	APPR.	DATE
DESIGNED BY	D.H.	DRAWN BY	D.H.
		CHECKED BY	

REHAB. OF ARTERIAL STREETS 96-97	ACCT. NO. 430-541500-440301-30038
JURUPA AVENUE PALM AVENUE TO RIVERSIDE AVENUE	XL-401-2 (R-3470) SHEET 2 OF 2
SCALE: 1" = 40'	FILE NAME: XL401-2.DWG