

RIVERWALK PARKWAY

SIGNING AND STRIPING NOTES:

1. TRAFFIC STRIPING, PAVEMENT MARKINGS AND RAISED PAVEMENT MARKERS PER CALTRANS TRAFFIC MANUAL, MAINTENANCE MANUAL, STD. PLANS AND SPECIFICATIONS, LATEST EDITIONS.
2. ALL STRIPES, SIGNS AND PAVEMENT MARKINGS SHALL BE REFLECTORIZED. STENCILS FOR PAVEMENT MARKINGS SHALL MATCH CITY OF RIVERSIDE STENCILS.
3. ALL CONFLICTING STRIPES AND PAVEMENT MARKINGS SHALL BE REMOVED BY WET SANDBLASTING. CONFLICTING SIGN AND RAISED PAVEMENT MARKERS SHALL BE REMOVED. ALL REMOVALS SHALL BE THE RESPONSIBILITY OF THE DEVELOPER.
4. ALL STRIPES SHALL BE APPLIED IN TWO COATS.
5. ALL REMOVED SIGNS SHALL BE SALVAGED AND DELIVERED TO THE CITY YARD.
6. ALL PAVEMENT MARKINGS AND LEGENDS SHALL BE THERMOPLASTIC
7. ALL STRIPING, PAVEMENT MARKINGS AND SIGN REQUIREMENTS (REMOVALS AND INSTALLATIONS) SHALL BE COMPLETED AT LEAST ONE DAY PRIOR TO TRAFFIC SIGNAL TURN ON.

LEGEND

- # INSTALL STRIPING DETAIL PER CALTRANS STD. PLAN A20A-A20D
- 1 INSTALL 12" SOLID WHITE (CROSSWALK OR STOP BAR)
- 2 INSTALL 4" "BIKE", "LANE" AND ARROW MARKING AT 20' O.C.
- 3 PAINT MEDIAN NOSE REFLECTIVE YELLOW
- 4 INSTALL 100' - 4" SOLID WHITE
- 5 INSTALL "SIGNAL AHEAD" PAVEMENT MARKING
- 6 INSTALL "STOP" PAVEMENT MARKING
- 7 INSTALL 12" SOLID WHITE (45° DIAGONAL)
- ↩ INSTALL TYPE IV (L OR R) ARROW MARKING.
- INSTALL SIGN (AS SHOWN) & POST

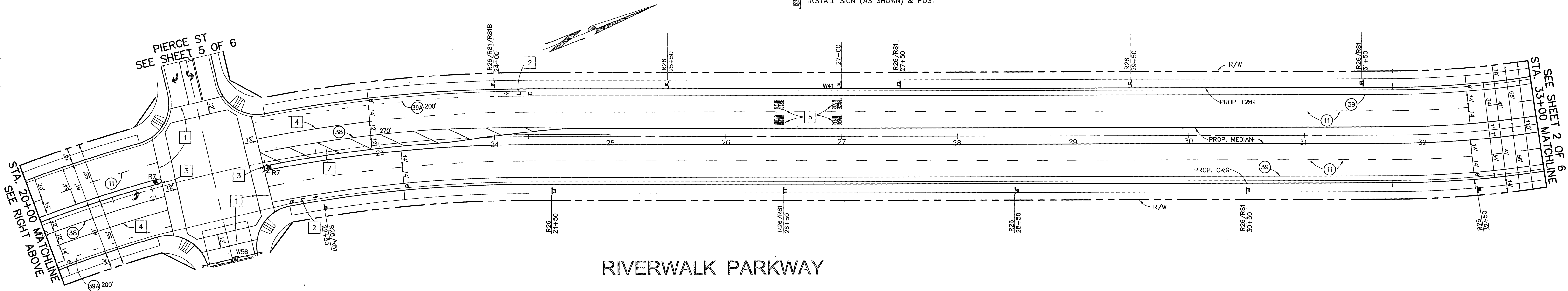

RIVERWALK PARKWAY

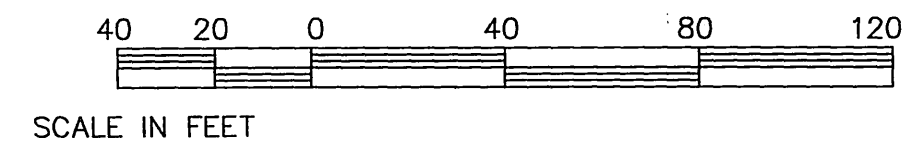

Underground Service Alert
Call: TOLL FREE
1 - 800
227-2600
TWO WORKING DAYS BEFORE YOU DIG

PRIVATE ENGINEERING NOTE
CONSTRUCTION CONTRACTOR AGREES THAT IN ACCORDANCE WITH GENERALLY ACCEPTED CONSTRUCTION PRACTICES, CONSTRUCTION CONTRACTOR WILL BE REQUIRED TO ASSUME SOLE AND COMPLETE RESPONSIBILITY FOR JOB SITE CONDITIONS DURING THE COURSE OF CONSTRUCTION OF THE PROJECT, INCLUDING SAFETY OF ALL PERSONS AND PROPERTY, THAT THIS REQUIREMENT SHALL BE MADE TO APPLY CONTINUOUSLY AND NOT BE LIMITED TO NORMAL WORKING HOURS, AND CONSTRUCTION CONTRACTOR FURTHER AGREES TO DEFEND, INDEMNIFY AND HOLD DESIGN PROFESSIONAL HARMLESS FROM ANY AND ALL LIABILITY, REAL OR ALLEGED, IN CONNECTION WITH THE PERFORMANCE OF WORK ON THIS PROJECT, EXCEPTING LIABILITY ARISING FROM THE SOLE NEGLIGENCE OF DESIGN PROFESSIONAL.

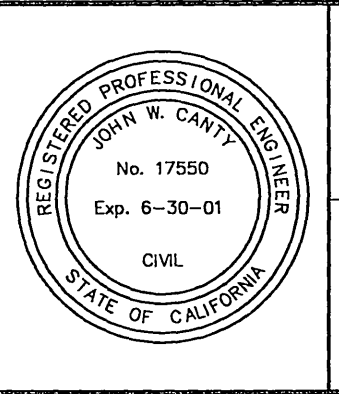

PREPARED UNDER THE DIRECTION OF:
Scott W. Canty
REGISTERED CIVIL ENGINEER NO. 17550
EXPIRATION DATE: 6-30-01 DATE: 10/24/00

CEG CANTY ENGINEERING GROUP, INC.
CIVIL ENGINEERING - PLANNING - SURVEYING
2020 IOWA AVENUE, SUITE 102, P.O. BOX 52050, RIVERSIDE, CA 92517
TEL (909) 683 - 5234 FAX (909) 683 - 5301
CITY OF RIV. BUSINESS TAX ACCT. NO. 69372 EXP. DATE 04-07-01
SCALE: 1"=40'
BENCH MARK: CITY OF RIV. B.M. E2-M3, PK NAIL & CITY ENGINEER TAG IN N'LY C.B. WING, W'LY CURB OF PIERCE ST. 1300' S'LY OF AMBS DR. ELEV.=694.231
DATE: OCTOBER, 2000

REVISION	DATE
1 REVISE SIGN & STRIPING	10/24/00
MARK	APPR. DATE
DESIGNED BY K.T.O.	DRAWN BY K.T.O. CHECKED BY J.W.C.

CITY OF RIVERSIDE, CALIFORNIA DEPARTMENT OF PUBLIC WORKS	
APPROVED BY	DATE
PRINCIPAL ENGR. <i>[Signature]</i>	11/21/00
TRAFFIC DIVISION	
P.W. ENGR. MGR. <i>[Signature]</i>	11/21/00
ST. SERVICES	
APPROVED BY	DATE
<i>[Signature]</i>	11-21-00
DIRECTOR OF PUBLIC WORKS	

IN THE CITY OF RIVERSIDE
LA SIERRA UNIVERSITY
SIGNING & STRIPING PLANS
RIVERWALK PARKWAY
STA. 10+00 TO 33+00
FOR: GRIFFIN INDUSTRIES

PROJECT NO.
XL-441
SHEET **1** OF **6**
FILE NO.: 1104-001

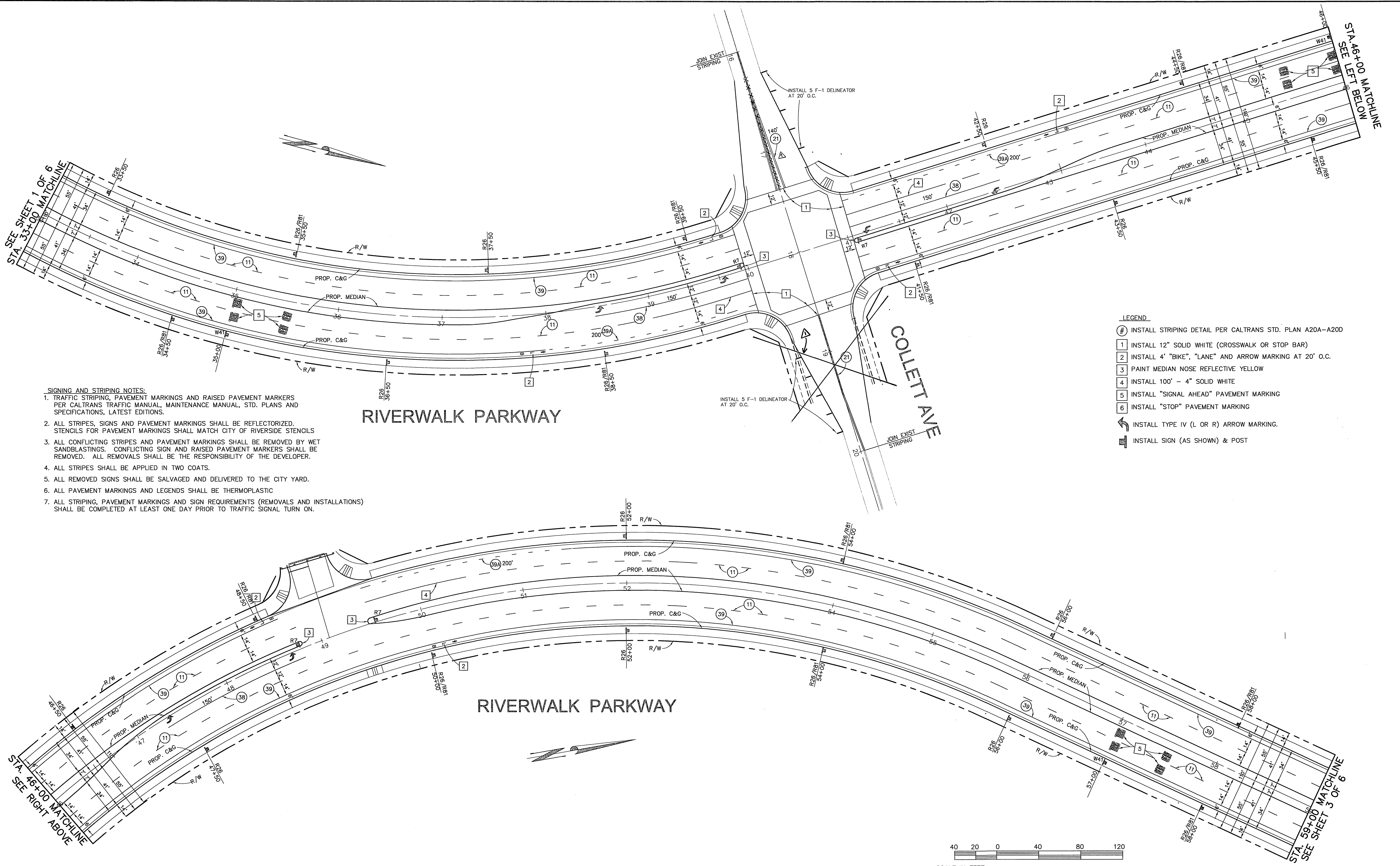

- SIGNING AND STRIPING NOTES:**
1. TRAFFIC STRIPING, PAVEMENT MARKINGS AND RAISED PAVEMENT MARKERS PER CALTRANS TRAFFIC MANUAL, MAINTENANCE MANUAL, STD. PLANS AND SPECIFICATIONS, LATEST EDITIONS.
 2. ALL STRIPES, SIGNS AND PAVEMENT MARKINGS SHALL BE REFLECTORIZED. STENCILS FOR PAVEMENT MARKINGS SHALL MATCH CITY OF RIVERSIDE STENCILS.
 3. ALL CONFLICTING STRIPES AND PAVEMENT MARKINGS SHALL BE REMOVED BY WET SANDBLASTINGS. CONFLICTING SIGN AND RAISED PAVEMENT MARKERS SHALL BE REMOVED. ALL REMOVALS SHALL BE THE RESPONSIBILITY OF THE DEVELOPER.
 4. ALL STRIPES SHALL BE APPLIED IN TWO COATS.
 5. ALL REMOVED SIGNS SHALL BE SALVAGED AND DELIVERED TO THE CITY YARD.
 6. ALL PAVEMENT MARKINGS AND LEGENDS SHALL BE THERMOPLASTIC
 7. ALL STRIPING, PAVEMENT MARKINGS AND SIGN REQUIREMENTS (REMOVALS AND INSTALLATIONS) SHALL BE COMPLETED AT LEAST ONE DAY PRIOR TO TRAFFIC SIGNAL TURN ON.

- LEGEND**
- # INSTALL STRIPING DETAIL PER CALTRANS STD. PLAN A20A-A20D
 - 1 INSTALL 12" SOLID WHITE (CROSSWALK OR STOP BAR)
 - 2 INSTALL 4' "BIKE", "LANE" AND ARROW MARKING AT 20' O.C.
 - 3 PAINT MEDIAN NOSE REFLECTIVE YELLOW
 - 4 INSTALL 100' - 4" SOLID WHITE
 - 5 INSTALL "SIGNAL AHEAD" PAVEMENT MARKING
 - 6 INSTALL "STOP" PAVEMENT MARKING
 - ↖ INSTALL TYPE IV (L OR R) ARROW MARKING.
 - INSTALL SIGN (AS SHOWN) & POST

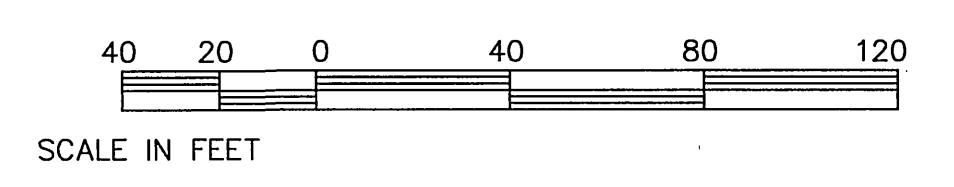

Underground Service Alert
 Call: TOLL FREE
 1 - 800
 227-2600
 TWO WORKING DAYS BEFORE YOU DIG

PRIVATE ENGINEERING NOTE
 CONSTRUCTION CONTRACTOR AGREES THAT IN ACCORDANCE WITH GENERALLY ACCEPTED CONSTRUCTION PRACTICES, CONSTRUCTION CONTRACTOR WILL BE REQUIRED TO ASSUME SOLE AND COMPLETE RESPONSIBILITY FOR JOB SITE CONDITIONS DURING THE COURSE OF CONSTRUCTION OF THE PROJECT, INCLUDING SAFETY OF ALL PERSONS AND PROPERTY; THAT THIS REQUIREMENT SHALL BE MADE TO APPLY CONTINUOUSLY AND NOT BE LIMITED TO NORMAL WORKING HOURS, AND CONSTRUCTION CONTRACTOR FURTHER AGREES TO DEFEND, INDEMNIFY AND HOLD DESIGN PROFESSIONAL HARMLESS FROM ANY AND ALL LIABILITY, REAL OR ALLEGED, IN CONNECTION WITH THE PERFORMANCE OF WORK ON THIS PROJECT, EXCEPTING LIABILITY ARISING FROM THE SOLE NEGLIGENCE OF DESIGN PROFESSIONAL.

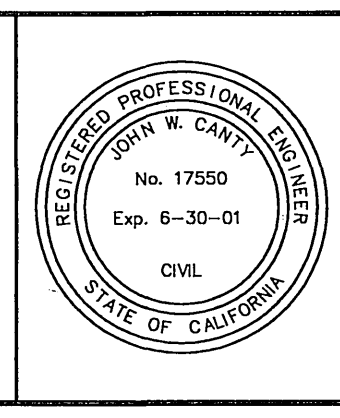

PREPARED UNDER THE DIRECTION OF:
John W. Canty
 REGISTERED CIVIL ENGINEER NO. 17550
 EXPIRATION DATE: 6-30-01 DATE: 10/26/00

CEC CANTY ENGINEERING GROUP, INC.
 CIVIL ENGINEERING - PLANNING - SURVEYING
 2020 IOWA AVENUE, SUITE 102, P.O. BOX 52050, RIVERSIDE, CA 92517
 TEL (909) 683 - 5234 FAX (909) 683 - 5301
 CITY OF RIV. BUSINESS TAX ACCT. NO. 69372 EXP. DATE 04-07-01
 SCALE: 1"=40'
 BENCH MARK: CITY OF RIV. B.M. E2-M3, PK NAIL & CITY ENGINEER TAG IN N'LY C.B. WING, WLY CURB OF PIERCE ST. 1300' S'LY OF AMBS DR. ELEV.=694.231
 DATE: OCTOBER, 2000

MARK	REVISIONS	APPR. DATE			
▲	REVISED COLLETT AVE. STRIPING	11/21/00			
DESIGNED BY	KTO	DRAWN BY	KTO	CHECKED BY	J.W.C.

CITY OF RIVERSIDE, CALIFORNIA
 DEPARTMENT OF PUBLIC WORKS

APPROVED BY	BY	DATE	APPROVED BY
PRINCIPAL ENGR.	<i>[Signature]</i>	11/21/00	<i>[Signature]</i>
TRAFFIC DIVISION	<i>[Signature]</i>		DIRECTOR OF PUBLIC WORKS
P.W. ENGR. MGR.	<i>[Signature]</i>		
ST. SERVICES	<i>[Signature]</i>		

DATE: 11-21-00

IN THE CITY OF RIVERSIDE
 LA SIERRA UNIVERSITY
 SIGNING & STRIPING PLANS
 RIVERWALK PARKWAY
 STA. 33+00 TO 59+00
 FOR: GRIFFIN INDUSTRIES

PROJECT NO.
XL-441
 SHEET **2** OF **6**
 FILE NO.: 1104-001

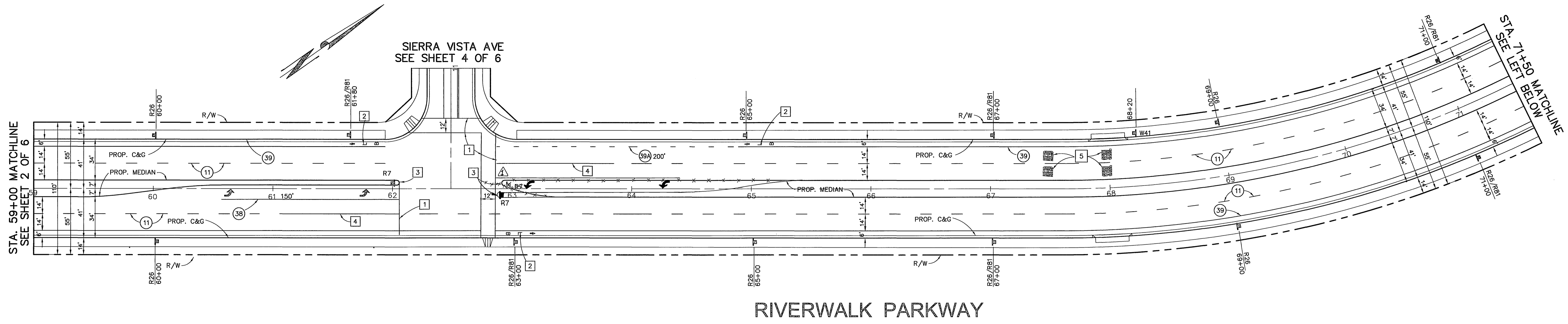

SIERRA VISTA AVE
SEE SHEET 4 OF 6

STA. 59+00 MATCHLINE
SEE SHEET 2 OF 6

STA. 71+50 MATCHLINE
SEE LEFT BELOW

RIVERWALK PARKWAY

- SIGNING AND STRIPING NOTES:**
1. TRAFFIC STRIPING, PAVEMENT MARKINGS AND RAISED PAVEMENT MARKERS PER CALTRANS TRAFFIC MANUAL, MAINTENANCE MANUAL, STD. PLANS AND SPECIFICATIONS, LATEST EDITIONS.
 2. ALL STRIPES, SIGNS AND PAVEMENT MARKINGS SHALL BE REFLECTORIZED. STENCILS FOR PAVEMENT MARKINGS SHALL MATCH CITY OF RIVERSIDE STENCILS.
 3. ALL CONFLICTING STRIPES AND PAVEMENT MARKINGS SHALL BE REMOVED BY WET SANDBLASTING. CONFLICTING SIGN AND RAISED PAVEMENT MARKERS SHALL BE REMOVED. ALL REMOVALS SHALL BE THE RESPONSIBILITY OF THE DEVELOPER.
 4. ALL STRIPES SHALL BE APPLIED IN TWO COATS.
 5. ALL REMOVED SIGNS SHALL BE SALVAGED AND DELIVERED TO THE CITY YARD.
 6. ALL PAVEMENT MARKINGS AND LEGENDS SHALL BE THERMOPLASTIC.
 7. ALL STRIPING, PAVEMENT MARKINGS AND SIGN REQUIREMENTS (REMOVALS AND INSTALLATIONS) SHALL BE COMPLETED AT LEAST ONE DAY PRIOR TO TRAFFIC SIGNAL TURN ON.

- LEGEND**
- # INSTALL STRIPING DETAIL PER CALTRANS STD. PLAN A20A-A20D
 - # EXIST. STRIPING DETAIL PER CALTRANS STD. PLAN A20A-A20D TO REMAIN UNLESS OTHERWISE NOTED.
 - 1 INSTALL 12" SOLID WHITE (CROSSWALK OR STOP BAR)
 - 2 INSTALL 4' "BIKE", "LANE" AND ARROW MARKING AT 20' O.C.
 - 3 PAINT MEDIAN NOSE REFLECTIVE YELLOW
 - 4 INSTALL 100' - 4" SOLID WHITE
 - 5 INSTALL "SIGNAL AHEAD" PAVEMENT MARKING
 - 6 INSTALL "STOP" PAVEMENT MARKING
 - RM REMOVE EXIST. MARKING OR STRIPING
 - RP REPAINT EXIST. MARKING OR STRIPING
 - ← INSTALL TYPE IV (L OR R) ARROW MARKING.
 - INSTALL SIGN (AS SHOWN) & POST
 - ↻ INSTALL TYPE VII (RT) ARROW MARKING.

STA. 71+50 MATCHLINE
SEE RIGHT ABOVE

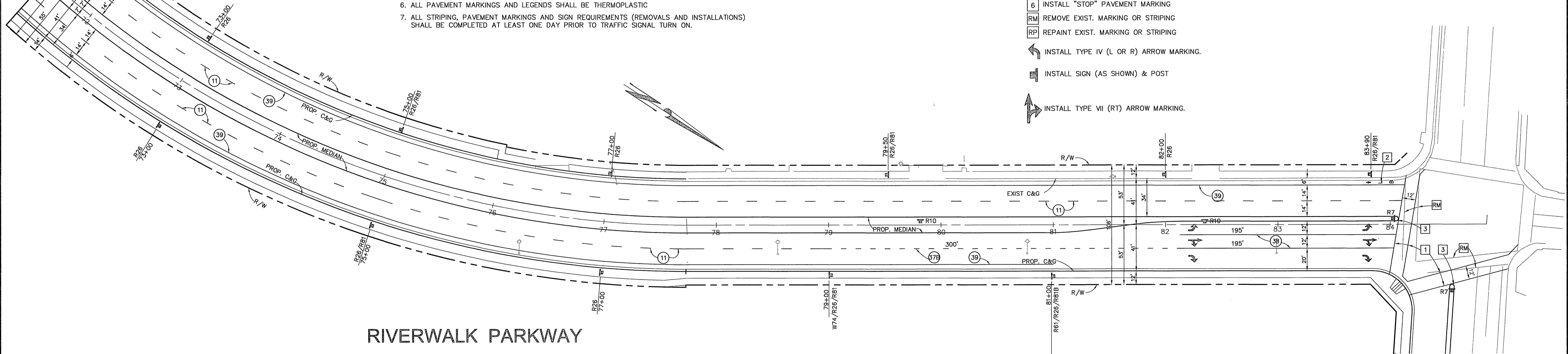

RIVERWALK PARKWAY

PIERCE STREET
SEE SHEET 6 OF 6

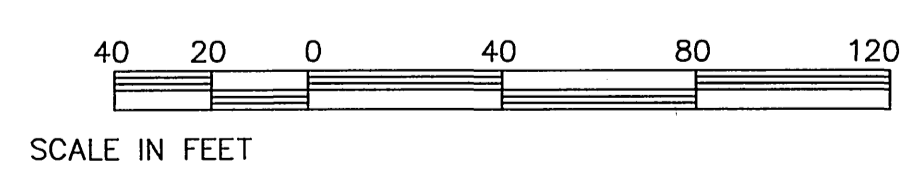
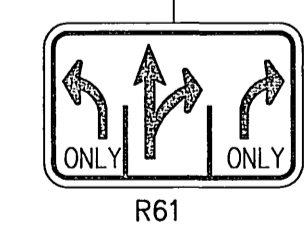

<p>Underground Service Alert</p> <p>Call: TOLL FREE 1 - 800 227-2600</p> <p>TWO WORKING DAYS BEFORE YOU DIG</p>	<p>PRIVATE ENGINEERING NOTE</p> <p>CONSTRUCTION CONTRACTOR AGREES THAT IN ACCORDANCE WITH GENERALLY ACCEPTED CONSTRUCTION PRACTICES, CONSTRUCTION CONTRACTOR WILL BE REQUIRED TO ASSUME SOLE AND COMPLETE RESPONSIBILITY FOR JOB SITE CONDITIONS DURING THE COURSE OF CONSTRUCTION OF THE PROJECT, INCLUDING SAFETY OF ALL PERSONS AND PROPERTY; THAT THIS REQUIREMENT SHALL BE MADE TO APPLY CONTINUOUSLY AND NOT BE LIMITED TO NORMAL WORKING HOURS, AND CONSTRUCTION CONTRACTOR FURTHER AGREES TO DEFEND, INDEMNIFY AND HOLD DESIGN PROFESSIONAL HARMLESS FROM ANY AND ALL LIABILITY, REAL OR ALLEGED, IN CONNECTION WITH THE PERFORMANCE OF WORK ON THIS PROJECT, EXCEPTING LIABILITY ARISING FROM THE SOLE NEGLIGENCE OF DESIGN PROFESSIONAL.</p>		<p>PREPARED UNDER THE DIRECTION OF:</p> <p>REGISTERED CIVIL ENGINEER NO. 17550</p> <p>EXPIRATION DATE: 6-30-01 DATE: _____</p>	<p>C&E CANTY ENGINEERING GROUP, INC.</p> <p>CIVIL ENGINEERING - PLANNING - SURVEYING</p> <p>2020 IOWA AVENUE, SUITE 102, P.O. BOX 52050, RIVERSIDE, CA 92517 TEL (909) 683 - 5234 FAX (909) 683 - 5301</p> <p>CITY OF RIV. BUSINESS TAX ACCT. NO. 69372 EXP. DATE 04-07-01</p> <p>SCALE: 1"=40' BENCH MARK: CITY OF RIV. B.M. E2-M3, PK NAIL & CITY ENGINEER TAG IN NLY C.B. WING, WLY CURB OF PIERCE ST. 1300' SLY OF AMBS DR. ELEV.=694.231</p> <p>DATE: OCTOBER, 2000</p>	<p>CITY OF RIVERSIDE, CALIFORNIA DEPARTMENT OF PUBLIC WORKS</p> <table border="1" style="width: 100%; border-collapse: collapse;"> <tr> <td>APPROVED BY</td> <td>BY</td> <td>DATE</td> <td>APPROVED BY</td> </tr> <tr> <td>PRINCIPAL ENGR.</td> <td><i>[Signature]</i></td> <td>3/18/01</td> <td><i>[Signature]</i></td> </tr> <tr> <td>TRAFFIC DIVISION</td> <td>CS</td> <td>11/18/00</td> <td>DIRECTOR OF PUBLIC WORKS</td> </tr> <tr> <td>P.W. ENGR. MGR.</td> <td>DB</td> <td>11/18/00</td> <td></td> </tr> <tr> <td>ST. SERVICES</td> <td>JA</td> <td>11/18/00</td> <td></td> </tr> </table> <p>DESIGNED BY K.T.O. DRAWN BY K.T.O. CHECKED BY J.W.C.</p>	APPROVED BY	BY	DATE	APPROVED BY	PRINCIPAL ENGR.	<i>[Signature]</i>	3/18/01	<i>[Signature]</i>	TRAFFIC DIVISION	CS	11/18/00	DIRECTOR OF PUBLIC WORKS	P.W. ENGR. MGR.	DB	11/18/00		ST. SERVICES	JA	11/18/00		<p>IN THE CITY OF RIVERSIDE LA SIERRA UNIVERSITY SIGNING & STRIPING PLAN RIVERWALK PARKWAY STA. 59+00 TO 85+00</p> <p>FOR: GRIFFIN INDUSTRIES</p>	<p>PROJECT NO. XL-441</p> <p>SHEET 3 OF 6</p> <p>FILE NO.: 1104-001</p>
APPROVED BY	BY	DATE	APPROVED BY																								
PRINCIPAL ENGR.	<i>[Signature]</i>	3/18/01	<i>[Signature]</i>																								
TRAFFIC DIVISION	CS	11/18/00	DIRECTOR OF PUBLIC WORKS																								
P.W. ENGR. MGR.	DB	11/18/00																									
ST. SERVICES	JA	11/18/00																									

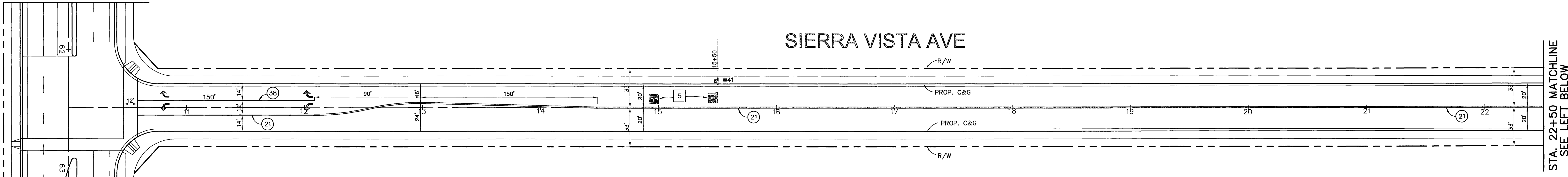

STA. 22+50 MATCHLINE
SEE LEFT BELOW

LEGEND

- # INSTALL STRIPING DETAIL PER CALTRANS STD. PLAN A20A-A20D
- # EXIST. STRIPING DETAIL PER CALTRANS STD. PLAN A20A-A20D TO REMAIN UNLESS OTHERWISE NOTED.
- 1 INSTALL 12" SOLID WHITE (CROSSWALK OR STOP BAR)
- 3 PAINT MEDIAN NOSE REFLECTIVE YELLOW
- 4 INSTALL "STOP" PAVEMENT MARKING
- 5 INSTALL "SIGNAL AHEAD" PAVEMENT MARKING
- RM REMOVE EXIST. MARKING OR STRIPING
- RP REPAINT EXIST. MARKING OR STRIPING
- ↩ INSTALL TYPE IV (L OR R) ARROW MARKING.
- INSTALL SIGN (AS SHOWN) & POST
- ⌚ EXISTING SIGN (AS SHOWN) & POST TO BE REMAIN UNLESS OTHERWISE NOTED.

SIGNING AND STRIPING NOTES:

1. TRAFFIC STRIPING, PAVEMENT MARKINGS AND RAISED PAVEMENT MARKERS PER CALTRANS TRAFFIC MANUAL, MAINTENANCE MANUAL, STD. PLANS AND SPECIFICATIONS, LATEST EDITIONS.
2. ALL STRIPES, SIGNS AND PAVEMENT MARKINGS SHALL BE REFLECTORIZED. STENCILS FOR PAVEMENT MARKINGS SHALL MATCH CITY OF RIVERSIDE STENCILS
3. ALL CONFLICTING STRIPES AND PAVEMENT MARKINGS SHALL BE REMOVED BY WET SANDBLASTINGS. CONFLICTING SIGN AND RAISED PAVEMENT MARKERS SHALL BE REMOVED. ALL REMOVALS SHALL BE THE RESPONSIBILITY OF THE DEVELOPER.
4. ALL STRIPES SHALL BE APPLIED IN TWO COATS.
5. ALL REMOVED SIGNS SHALL BE SALVAGED AND DELIVERED TO THE CITY YARD.
6. ALL PAVEMENT MARKINGS AND LEGENDS SHALL BE THERMOPLASTIC
7. ALL STRIPING, PAVEMENT MARKINGS AND SIGN REQUIREMENTS (REMOVALS AND INSTALLATIONS) SHALL BE COMPLETED AT LEAST ONE DAY PRIOR TO TRAFFIC SIGNAL TURN ON.

STA. 22+50 MATCHLINE
SEE RIGHT ABOVE

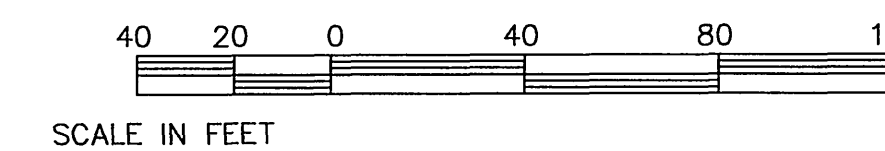
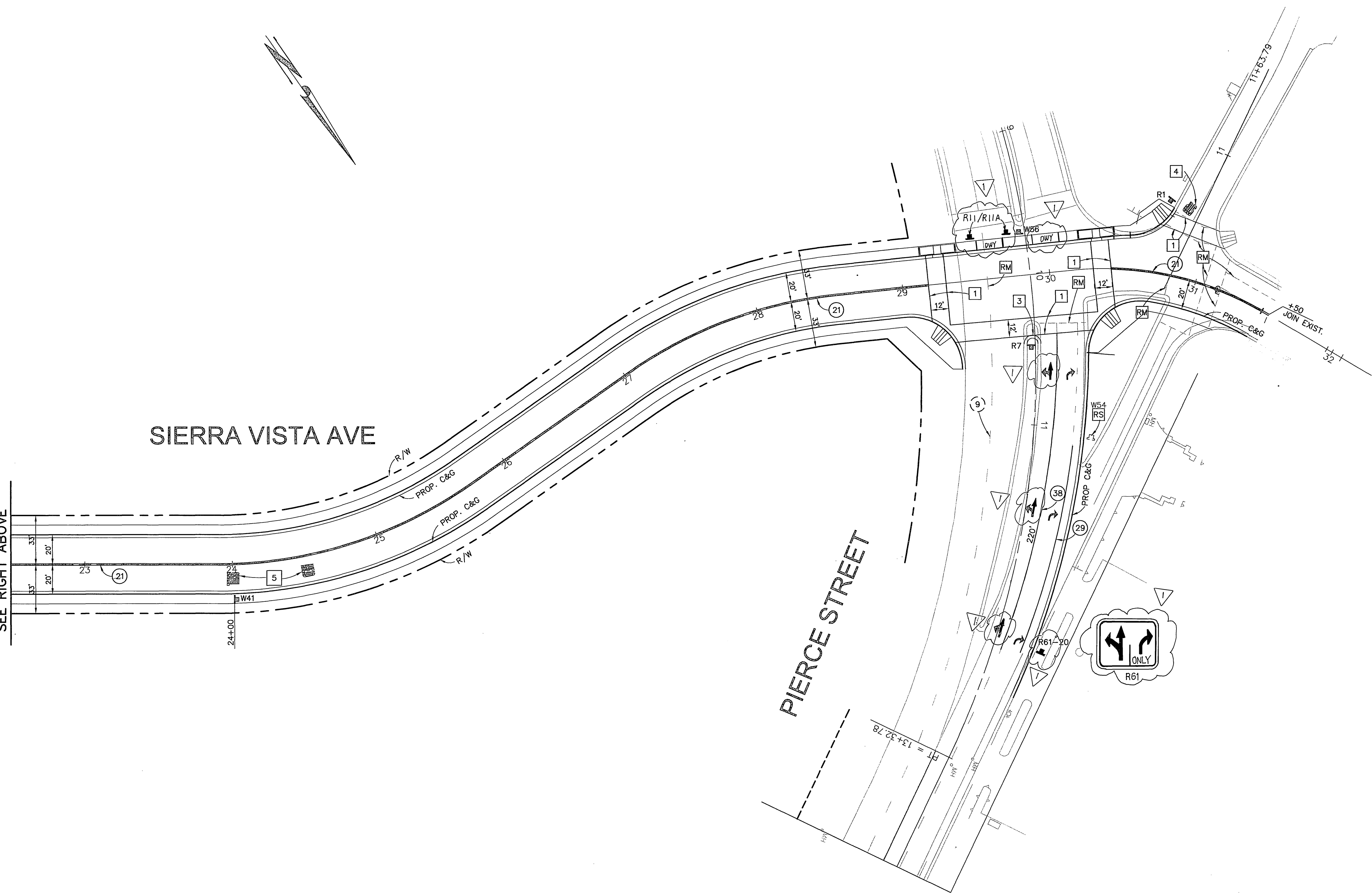

<p>Underground Service Alert</p> <p>Call: TOLL FREE 1 - 800 227-2600</p> <p>TWO WORKING DAYS BEFORE YOU DIG</p>	<p>PRIVATE ENGINEERING NOTE</p> <p>CONSTRUCTION CONTRACTOR AGREES THAT IN ACCORDANCE WITH GENERALLY ACCEPTED CONSTRUCTION PRACTICES, CONSTRUCTION CONTRACTOR WILL BE REQUIRED TO ASSUME SOLE AND COMPLETE RESPONSIBILITY FOR JOB SITE CONDITIONS DURING THE COURSE OF CONSTRUCTION OF THE PROJECT, INCLUDING SAFETY OF ALL PERSONS AND PROPERTY, THAT THIS REQUIREMENT SHALL BE MADE TO APPLY CONTINUOUSLY AND NOT BE LIMITED TO NORMAL WORKING HOURS, AND CONSTRUCTION CONTRACTOR FURTHER AGREES TO DEFEND, INDEMNIFY AND HOLD DESIGN PROFESSIONAL HARMLESS FROM ANY AND ALL LIABILITY, REAL OR ALLEGED, IN CONNECTION WITH THE PERFORMANCE OF WORK ON THIS PROJECT, EXCEPTING LIABILITY ARISING FROM THE SOLE NEGLIGENCE OF DESIGN PROFESSIONAL.</p>		<p>PREPARED UNDER THE DIRECTION OF:</p> <p><i>R. W. Canty</i></p> <p>REGISTERED CIVIL ENGINEER NO. 17550</p> <p>EXPIRATION DATE: 6-30-01 DATE: 1/20/00</p>	<p>CANTY ENGINEERING GROUP, INC. CIVIL ENGINEERING - PLANNING - SURVEYING</p> <p>2020 IOWA AVENUE, SUITE 102, P.O. BOX 52050, RIVERSIDE, CA 92517 TEL (909) 683 - 5234 FAX (909) 683 - 5301</p> <p>CITY OF RIV. BUSINESS TAX ACCT. NO. 69372 EXP. DATE 04-07-01</p> <p>SCALE: 1"=40' DATE: OCTOBER 2000</p> <p>BENCH MARK: CITY OF RIV. B.M. E2-M3, PK NAIL & CITY ENGINEER TAG IN N'LY C.B. WING, W'LY CURB OF PIERCE ST. 1300' S'LY OF AMBS DR. ELEV.=694.231</p>	<p>CITY OF RIVERSIDE, CALIFORNIA DEPARTMENT OF PUBLIC WORKS</p> <p>APPROVED BY: <i>R. W. Canty</i> 11/1/00 PRINCIPAL ENGR.</p> <p>TRAFFIC DIVISION</p> <p>P.W. ENGR. MGR. <i>R. W. Canty</i> 11/1/00</p> <p>ST. SERVICES</p>	<p>IN THE CITY OF RIVERSIDE LA SIERRA UNIVERSITY SIGNING & STRIPING PLANS SIERRA VISTA AVE STA. 10+00 TO 33+00</p> <p>FOR: GRIFFIN INDUSTRIES</p>	<p>PROJECT NO. XL-441</p> <p>SHEET 4 OF 6</p> <p>FILE NO.: 1104-001</p>
---	--	--	--	--	--	---	--

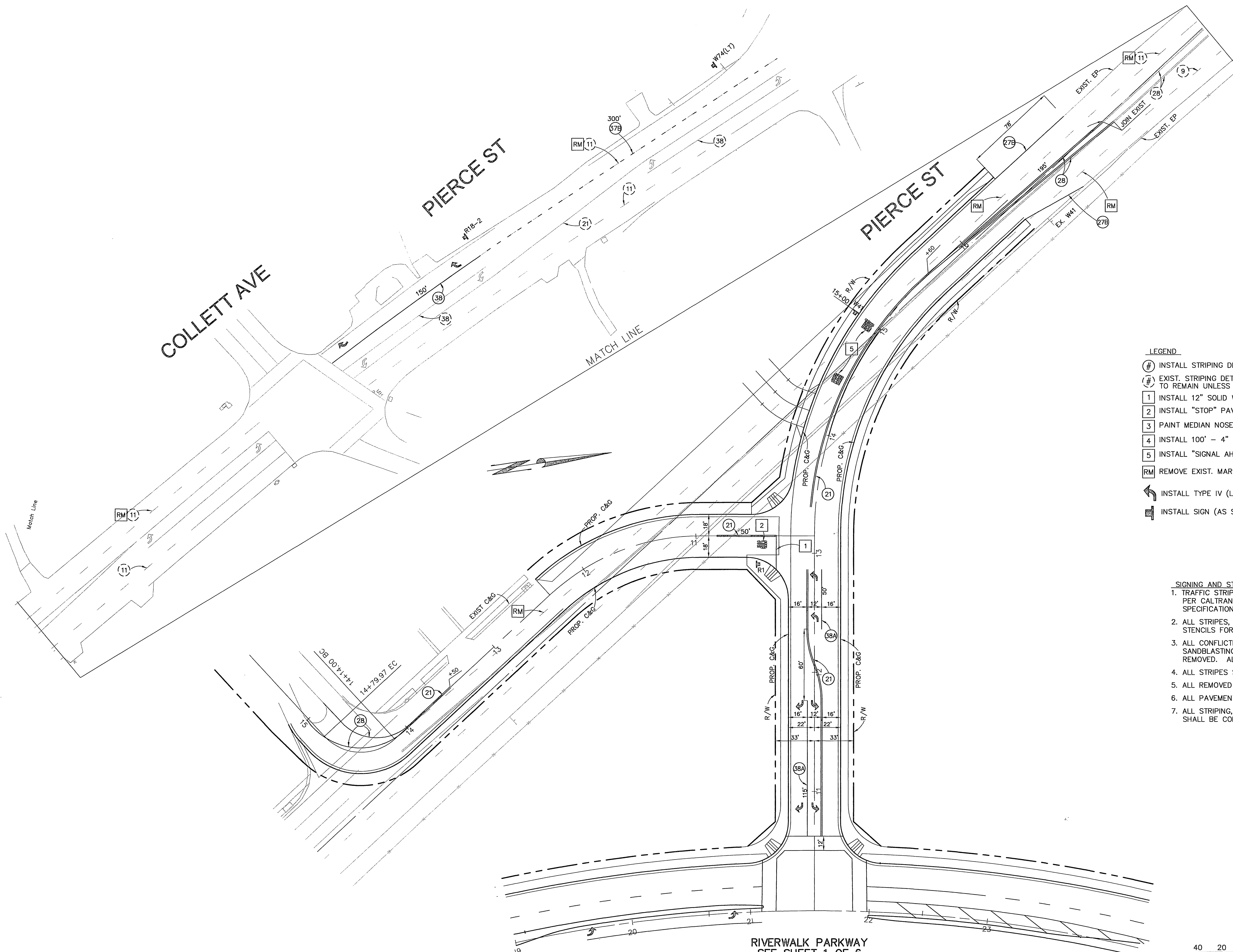

LEGEND

- # INSTALL STRIPING DETAIL PER CALTRANS STD. PLAN A20A-A20D
- # EXIST. STRIPING DETAIL PER CALTRANS STD. PLAN A20A-A20D TO REMAIN UNLESS OTHERWISE NOTED
- 1 INSTALL 12" SOLID WHITE (CROSSWALK OR STOP BAR)
- 2 INSTALL "STOP" PAVEMENT MARKING
- 3 PAINT MEDIAN NOSE REFLECTIVE YELLOW
- 4 INSTALL 100' - 4" SOLID WHITE
- 5 INSTALL "SIGNAL AHEAD" PAVEMENT MARKING
- RM REMOVE EXIST. MARKING OR STRIPING
- ↔ INSTALL TYPE IV (L OR R) ARROW MARKING.
- INSTALL SIGN (AS SHOWN) & POST

SIGNING AND STRIPING NOTES:

1. TRAFFIC STRIPING, PAVEMENT MARKINGS AND RAISED PAVEMENT MARKERS PER CALTRANS TRAFFIC MANUAL, MAINTENANCE MANUAL, STD. PLANS AND SPECIFICATIONS, LATEST EDITIONS.
2. ALL STRIPES, SIGNS AND PAVEMENT MARKINGS SHALL BE REFLECTORIZED. STENCILS FOR PAVEMENT MARKINGS SHALL MATCH CITY OF RIVERSIDE STENCILS.
3. ALL CONFLICTING STRIPES AND PAVEMENT MARKINGS SHALL BE REMOVED BY WET SANDBLASTING. CONFLICTING SIGN AND RAISED PAVEMENT MARKERS SHALL BE REMOVED. ALL REMOVALS SHALL BE THE RESPONSIBILITY OF THE DEVELOPER.
4. ALL STRIPES SHALL BE APPLIED IN TWO COATS.
5. ALL REMOVED SIGNS SHALL BE SALVAGED AND DELIVERED TO THE CITY YARD.
6. ALL PAVEMENT MARKINGS AND LEGENDS SHALL BE THERMOPLASTIC
7. ALL STRIPING, PAVEMENT MARKINGS AND SIGN REQUIREMENTS (REMOVALS AND INSTALLATIONS) SHALL BE COMPLETED AT LEAST ONE DAY PRIOR TO TRAFFIC SIGNAL TURN ON.

RIVERWALK PARKWAY
SEE SHEET 1 OF 6

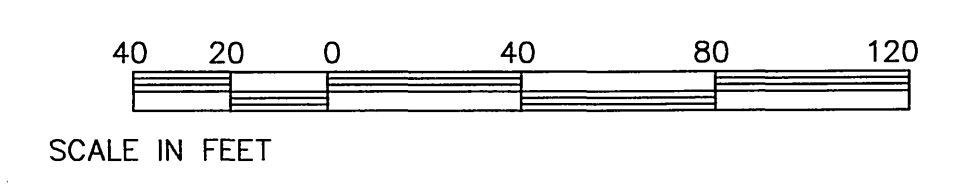

Underground Service Alert
Call: TOLL FREE
1 - 800
227-2600
TWO WORKING DAYS BEFORE YOU DIG

PRIVATE ENGINEERING NOTE
CONSTRUCTION CONTRACTOR AGREES THAT IN ACCORDANCE WITH GENERALLY ACCEPTED CONSTRUCTION PRACTICES, CONSTRUCTION CONTRACTOR WILL BE REQUIRED TO ASSUME SOLE AND COMPLETE RESPONSIBILITY FOR JOB SITE CONDITIONS DURING THE COURSE OF CONSTRUCTION OF THE PROJECT, INCLUDING SAFETY OF ALL PERSONS AND PROPERTY. THAT THIS REQUIREMENT SHALL BE MADE TO APPLY CONTINUOUSLY AND NOT BE LIMITED TO NORMAL WORKING HOURS, AND CONSTRUCTION CONTRACTOR FURTHER AGREES TO DEFEND, INDEMNIFY AND HOLD DESIGN PROFESSIONAL HARMLESS FROM ANY AND ALL LIABILITY, REAL OR ALLEGED, IN CONNECTION WITH THE PERFORMANCE OF WORK ON THIS PROJECT, EXCEPTING LIABILITY ARISING FROM THE SOLE NEGLIGENCE OF DESIGN PROFESSIONAL.



PREPARED UNDER THE DIRECTION OF:
REGISTERED CIVIL ENGINEER NO. 17550
EXPIRATION DATE: 6-30-01 DATE: _____

CEC CANTY ENGINEERING GROUP, INC.
CIVIL ENGINEERING - PLANNING - SURVEYING
2020 IOWA AVENUE, SUITE 102, P.O. BOX 52050, RIVERSIDE, CA 92517
TEL (909) 683 - 5234 FAX (909) 683 - 5301
CITY OF RIV. BUSINESS TAX ACCT. NO. 69372 EXP. DATE 04-07-01
SCALE: 1"=40'
BENCH MARK: CITY OF RIV. B.M. 62-31, PK NAIL & CITY ENGINEER TAG IN N'LY C.B. WING, W'LY CURB OF PIERCE ST. 1300' S'LY OF AMBS DR. ELEV.=694.231
DATE: OCTOBER, 2000

MARK	REVISIONS	APPR.	DATE

DESIGNED BY P.J.C. DRAWN BY P.J.C. CHECKED BY J.W.C.

CITY OF RIVERSIDE, CALIFORNIA DEPARTMENT OF PUBLIC WORKS			
APPROVED BY	BY	DATE	APPROVED BY
PRINCIPAL ENGR.	<i>[Signature]</i>	11/21/00	<i>[Signature]</i>
TRAFFIC DIVISION	<i>[Signature]</i>	11/21/00	DIRECTOR OF PUBLIC WORKS
P.W. ENGR. MGR.	<i>[Signature]</i>	11/21/00	DATE 11-21-00
ST. SERVICES	<i>[Signature]</i>	11/21/00	

IN THE CITY OF RIVERSIDE
LA SIERRA UNIVERSITY
SIGNING & STRIPING PLAN
PIERCE ST
STA. 10+00 TO 19+00
FOR: GRIFFIN INDUSTRIES

PROJECT NO.
XL-441
SHEET **5** OF **6**
FILE NO.: 1104-001

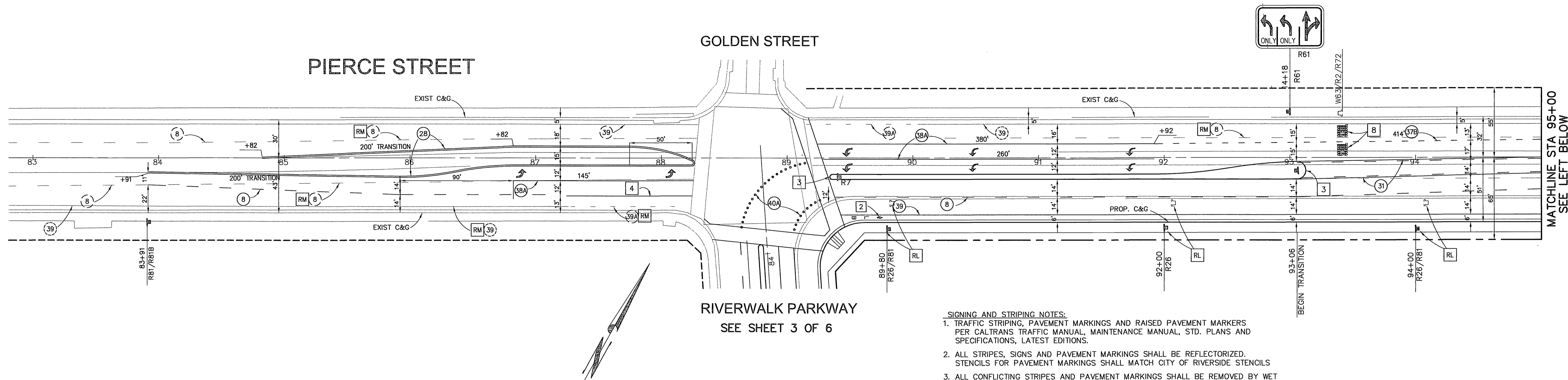

GOLDEN STREET

PIERCE STREET

RIVERWALK PARKWAY
SEE SHEET 3 OF 6

MATCHLINE STA 95+00
SEE LEFT BELOW

LEGEND

- ⑧ INSTALL STRIPING DETAIL PER CALTRANS STD. PLAN A20A-A20D
- Ⓜ EXIST. STRIPING DETAIL PER CALTRANS STD. PLAN A20A-A20D TO REMAIN UNLESS OTHERWISE NOTED.
- 1 INSTALL 12" SOLID WHITE (CROSSWALK OR STOP BAR)
- 2 INSTALL "STOP" PAVEMENT MARKING
- 3 PAINT MEDIAN NOSE REFLECTIVE YELLOW
- 4 INSTALL 100' - 4" SOLID WHITE
- 5 INSTALL "SIGNAL AHEAD" PAVEMENT MARKING
- 8 INSTALL "SCHOOL" YELLOW PAVEMENT MARKING
- RL RELOCATE EXIST SIGN AND POST
- RM REMOVE EXIST. MARKING OR STRIPING
- ↔ INSTALL TYPE IV (L OR R) ARROW MARKING.
- Ⓜ INSTALL SIGN (AS SHOWN) & POST

SIGNING AND STRIPING NOTES:

1. TRAFFIC STRIPING, PAVEMENT MARKINGS AND RAISED PAVEMENT MARKERS PER CALTRANS TRAFFIC MANUAL, MAINTENANCE MANUAL, STD. PLANS AND SPECIFICATIONS, LATEST EDITIONS.
2. ALL STRIPES, SIGNS AND PAVEMENT MARKINGS SHALL BE REFLECTORIZED. STENCILS FOR PAVEMENT MARKINGS SHALL MATCH CITY OF RIVERSIDE STENCILS
3. ALL CONFLICTING STRIPES AND PAVEMENT MARKINGS SHALL BE REMOVED BY WET SANDBLASTING. CONFLICTING SIGN AND RAISED PAVEMENT MARKERS SHALL BE REMOVED. ALL REMOVALS SHALL BE THE RESPONSIBILITY OF THE DEVELOPER.
4. ALL STRIPES SHALL BE APPLIED IN TWO COATS.
5. ALL REMOVED SIGNS SHALL BE SALVAGED AND DELIVERED TO THE CITY YARD.
6. ALL PAVEMENT MARKINGS AND LEGENDS SHALL BE THERMOPLASTIC
7. ALL STRIPING, PAVEMENT MARKINGS AND SIGN REQUIREMENTS (REMOVALS AND INSTALLATIONS) SHALL BE COMPLETED AT LEAST ONE DAY PRIOR TO TRAFFIC SIGNAL TURN ON.

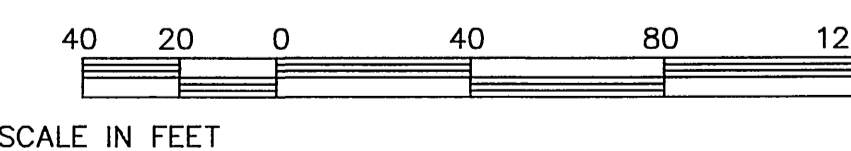
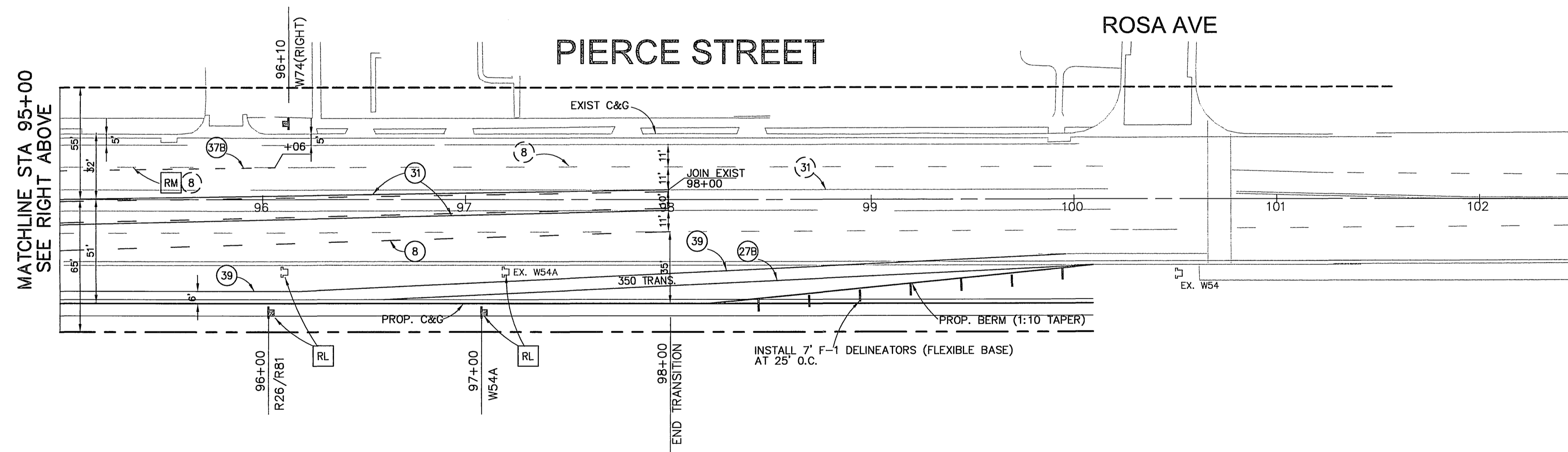

<p>Underground Service Alert</p> <p>Call: TOLL FREE 1 - 800 227-2600</p> <p>TWO WORKING DAYS BEFORE YOU DIG</p>	<p>PRIVATE ENGINEERING NOTE</p> <p>CONSTRUCTION CONTRACTOR AGREES THAT IN ACCORDANCE WITH GENERALLY ACCEPTED CONSTRUCTION PRACTICES, CONSTRUCTION CONTRACTOR WILL BE REQUIRED TO ASSUME SOLE AND COMPLETE RESPONSIBILITY FOR JOB SITE CONDITIONS DURING THE COURSE OF CONSTRUCTION OF THE PROJECT, INCLUDING SAFETY OF ALL PERSONS AND PROPERTY. THAT THIS REQUIREMENT SHALL BE MADE TO APPLY CONTINUOUSLY AND NOT BE LIMITED TO NORMAL WORKING HOURS, AND CONSTRUCTION CONTRACTOR FURTHER AGREES TO DEFEND, INDEMNIFY AND HOLD DESIGN PROFESSIONAL HARMLESS FROM ANY AND ALL LIABILITY, REAL OR ALLEGED, IN CONNECTION WITH THE PERFORMANCE OF WORK ON THIS PROJECT, EXCEPTING LIABILITY ARISING FROM THE SOLE NEGLIGENCE OF DESIGN PROFESSIONAL.</p>		<p>PREPARED UNDER THE DIRECTION OF:</p> <p>REGISTERED CIVIL ENGINEER NO. 17550</p> <p>EXPIRATION DATE: 6-30-01 DATE: _____</p>	<p>CANTY ENGINEERING GROUP, INC. CIVIL ENGINEERING - PLANNING - SURVEYING</p> <p>2020 IOWA AVENUE, SUITE 102, P.O. BOX 52050, RIVERSIDE, CA 92517 TEL (909) 683 - 5234 FAX (909) 683 - 5301</p> <p>CITY OF RIV. BUSINESS TAX ACCT. NO. 69372 EXP. DATE 04-07-01</p> <p>SCALE: 1"=40'</p> <p>BENCH MARK: CITY OF RIV. B.M. E2-M3, PK NAIL & CITY ENGINEER TAG IN N'LY C.B. WING, W'LY CURB OF PIERCE ST. 1300' S'LY OF AMBS DR. DATE: OCTOBER, 2000 ELEV.=694.231</p>	<p>CITY OF RIVERSIDE, CALIFORNIA DEPARTMENT OF PUBLIC WORKS</p> <table border="1" style="width: 100%; border-collapse: collapse;"> <tr> <td>APPROVED BY</td> <td>BY</td> <td>DATE</td> <td>APPROVED BY</td> </tr> <tr> <td>PRINCIPAL ENGR.</td> <td><i>[Signature]</i></td> <td>11/20/00</td> <td><i>[Signature]</i></td> </tr> <tr> <td>TRAFFIC DIVISION</td> <td><i>[Signature]</i></td> <td></td> <td>DIRECTOR OF PUBLIC WORKS</td> </tr> <tr> <td>P.W. ENGR. MGR.</td> <td><i>[Signature]</i></td> <td></td> <td></td> </tr> <tr> <td>ST. SERVICES</td> <td><i>[Signature]</i></td> <td></td> <td></td> </tr> </table> <p>DESIGNED BY K.T.O. DRAWN BY K.T.O. CHECKED BY J.W.C.</p>	APPROVED BY	BY	DATE	APPROVED BY	PRINCIPAL ENGR.	<i>[Signature]</i>	11/20/00	<i>[Signature]</i>	TRAFFIC DIVISION	<i>[Signature]</i>		DIRECTOR OF PUBLIC WORKS	P.W. ENGR. MGR.	<i>[Signature]</i>			ST. SERVICES	<i>[Signature]</i>			<p>IN THE CITY OF RIVERSIDE LA SIERRA UNIVERSITY SIGNING & STRIPING PLAN</p> <p>PIERCE STREET STA. 83+00 TO 101+00</p> <p>FOR: GRIFFIN INDUSTRIES</p>	<p>PROJECT NO.</p> <p>XL-441</p> <p>SHEET 6 OF 6</p> <p>FILE NO.: 1104-001</p>
APPROVED BY	BY	DATE	APPROVED BY																								
PRINCIPAL ENGR.	<i>[Signature]</i>	11/20/00	<i>[Signature]</i>																								
TRAFFIC DIVISION	<i>[Signature]</i>		DIRECTOR OF PUBLIC WORKS																								
P.W. ENGR. MGR.	<i>[Signature]</i>																										
ST. SERVICES	<i>[Signature]</i>																										