

SIGNING & STRIPING PLAN

IN THE CITY OF RIVERSIDE

CREST AVENUE

STA. 0+00 TO 5+39

(NORTH OF ARLINGTON AVENUE)

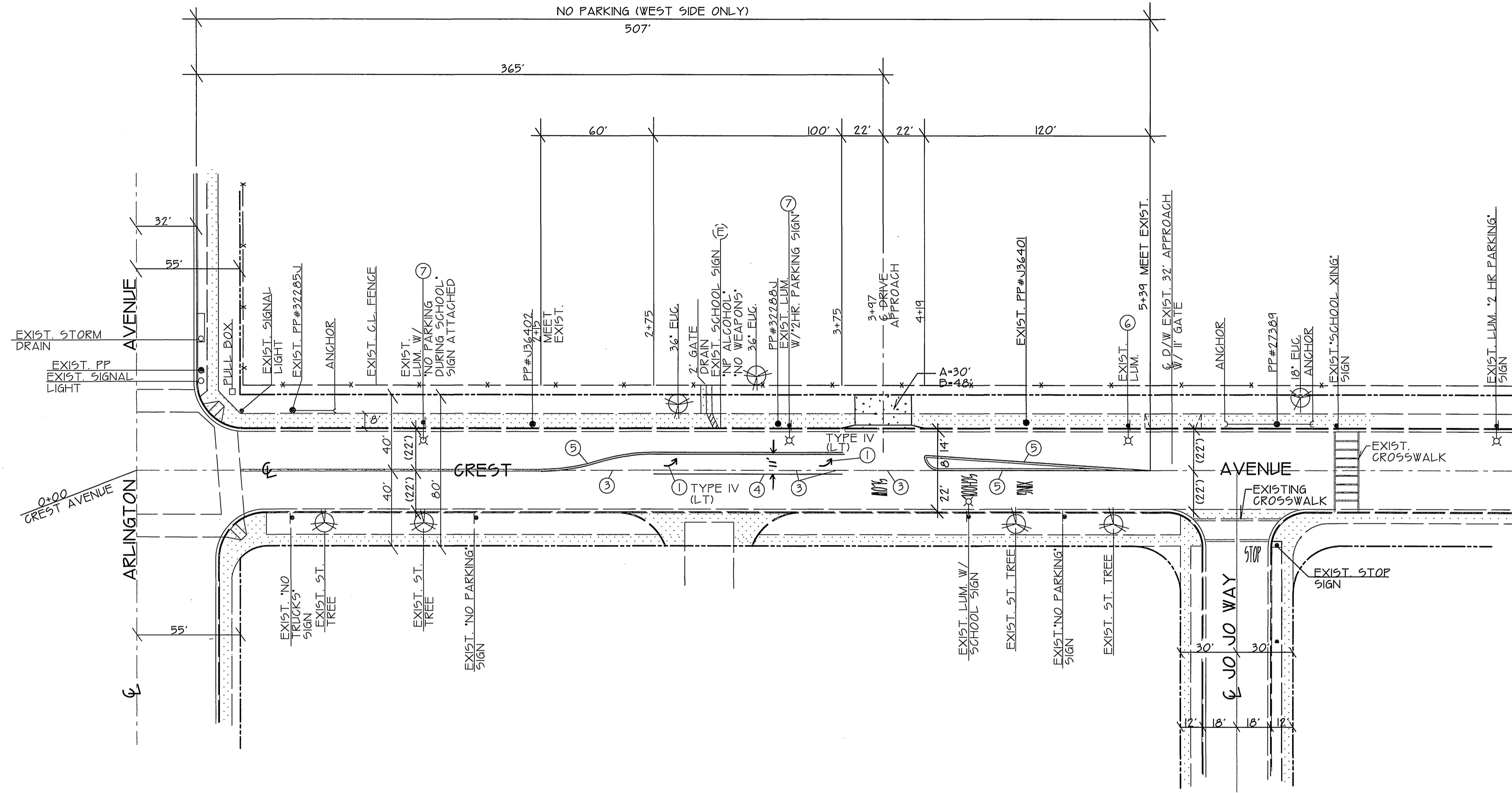
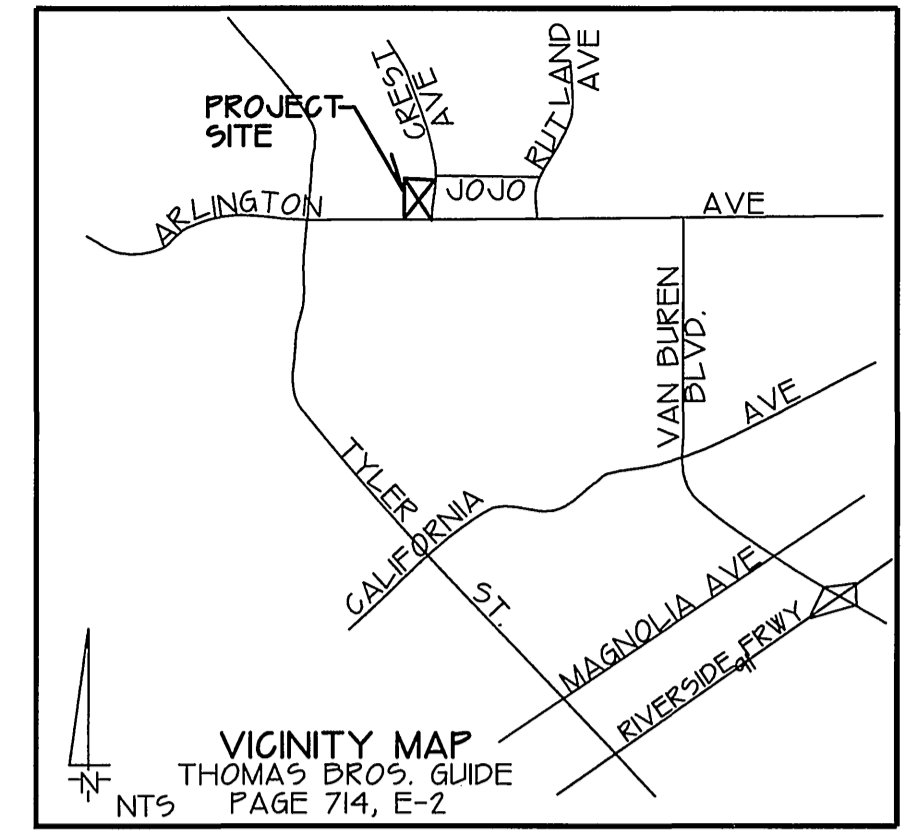

- CONSTRUCTION NOTES**
- (E) EXISTING SIGNAGE TO REMAIN
 - ① PAVEMENT MARKINGS PER CALTRANS STANDARDS
ALL PAVEMENT MARKINGS SHALL BE THERMOPLASTIC.
 - ② INSTALL CALTRANS 'NO PARKING' SIGN-R26 ON EXISTING POLE
 - ③ WET SANDBLAST CONFLICTING STRIPING REMOVE CONFLICTING RAISED PAVEMENT MARKERS.
 - ④ INSTALL 8" SOLID WHITE CHANNELIZING LINE PER CALTRANS STD.
 - ⑤ PAINT DOUBLE YELLOW STRIPE PER CALTRANS STD.
 - ⑥ INSTALL CALTRANS 'NO PARKING' SIGN-R26 TO EXISTING POLE.
 - ⑦ EXISTING 'NO PARKING DURING SCHOOL HOURS' TO BE REPLACED PER NOTE 2 ABOVE.

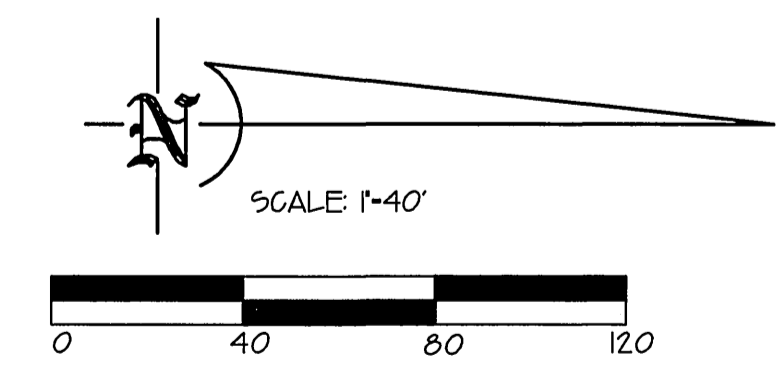

CITY OF RIVERSIDE PUBLIC UTILITIES DEPARTMENT-ELECTRIC OVERHEAD & UNDERGROUND	CITY OF RIVERSIDE WATER DEPT.
APPROVED BY _____ DATE _____	APPROVED BY _____ DATE _____

UNDERGROUND SERVICE ALERT

Call: Toll FREE
1-800-227-2600

TWO WORKING DAYS BEFORE YOU DIG

*CAUTION: Remember that the USA Center locates only those utilities belonging to the center. There could be other utilities present at the work site. The center will inform you of whom they will notify.

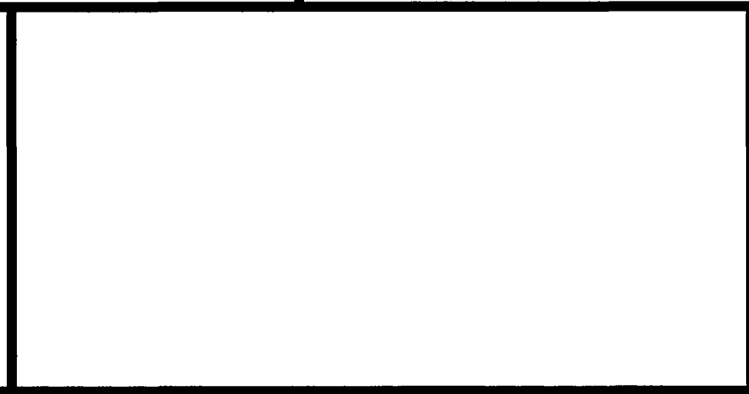

PREPARED UNDER THE DIRECTION OF:

MELVIN W. THATCHER, III
R.C.E. NO. 34964
EXPIRATION DATE: 12-31-01 DATE: 5/14/00

THATCHER ENGINEERING & ASSOCIATES, INC.
94650 COUNTY LINE ROAD, STE. 4
YUCAIPA, CA. 92399
(909) 795-1410 FAX (909) 795-1400

Melvin W. Thatcher, III R.C.E. 39964 Exp. Dec 31, 2001

SCALE: 1"=40'
DATE: 5/12/00

CITY BUSINESS TAX CERT. NO. 059169
EXP. DATE: 6/1/00

DESIGNED BY: M.W.T.	DRAWN BY: G.H./J.V.
CHECKED BY: K.M.	APPR. DATE: _____

CITY OF RIVERSIDE, CALIFORNIA
DEPARTMENT OF PUBLIC WORKS

APPROVED BY	BY DATE
PRINCIPAL ENGR.	<i>R. McGrath</i> 7/13/00
PARK DEPARTMENT	
TRAFFIC DIVISION	
P.W. ENGR. MANAGER	

DATE 7-13-00

IN THE CITY OF RIVERSIDE
SIGNING & STRIPING PLANS
CREST STREET
STA. 0+00 TO 5+39
(NORTH OF ARLINGTON AVENUE)

FOR: _____

PROJECT NO.
XL-446

SHEET 1 OF 1

FILE NO.

SIGNING & STRIPING PLAN

IN THE CITY OF RIVERSIDE

CREST AVENUE

STA. 0+00 TO 5+39

(NORTH OF ARLINGTON AVENUE)

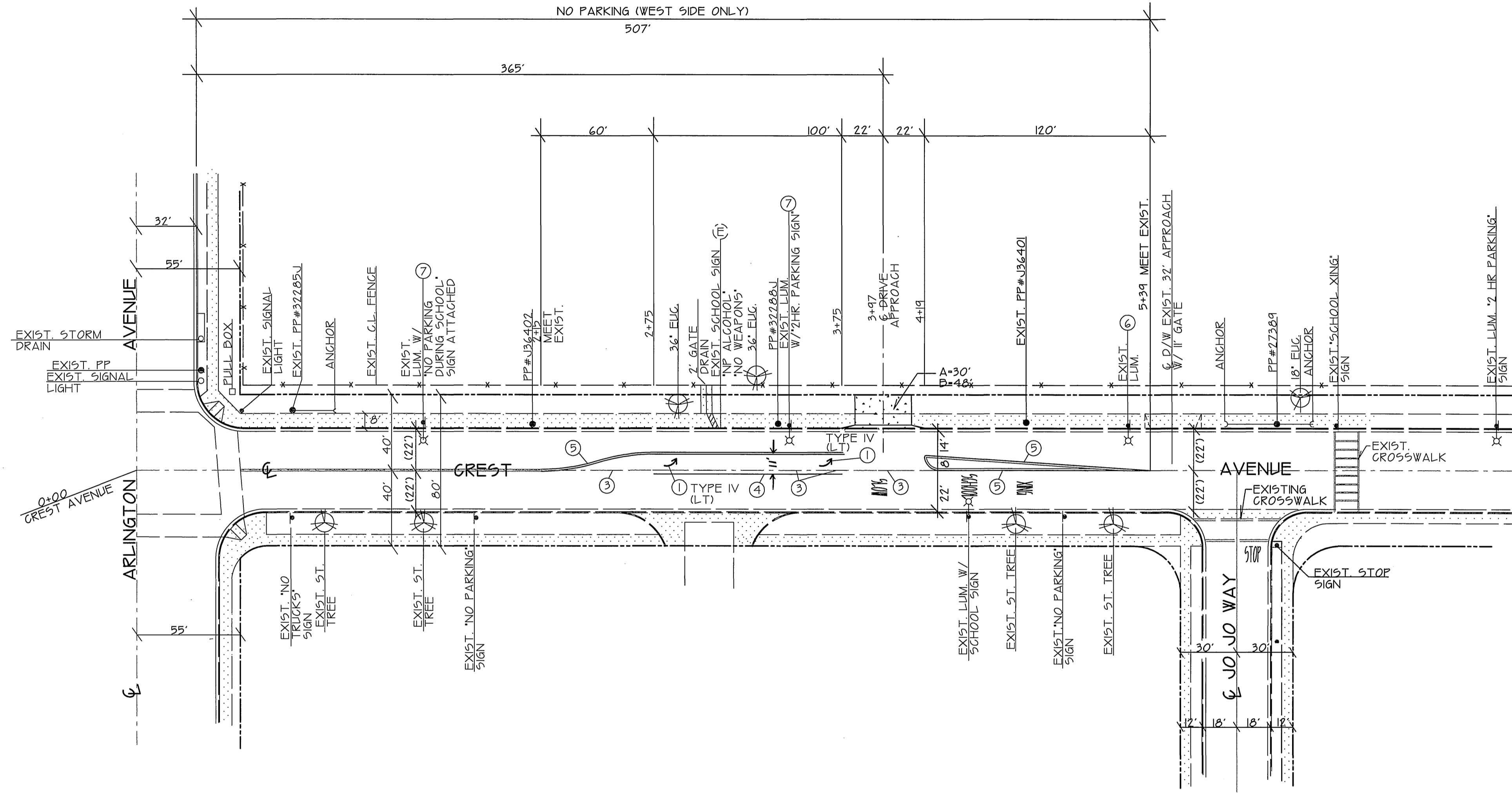
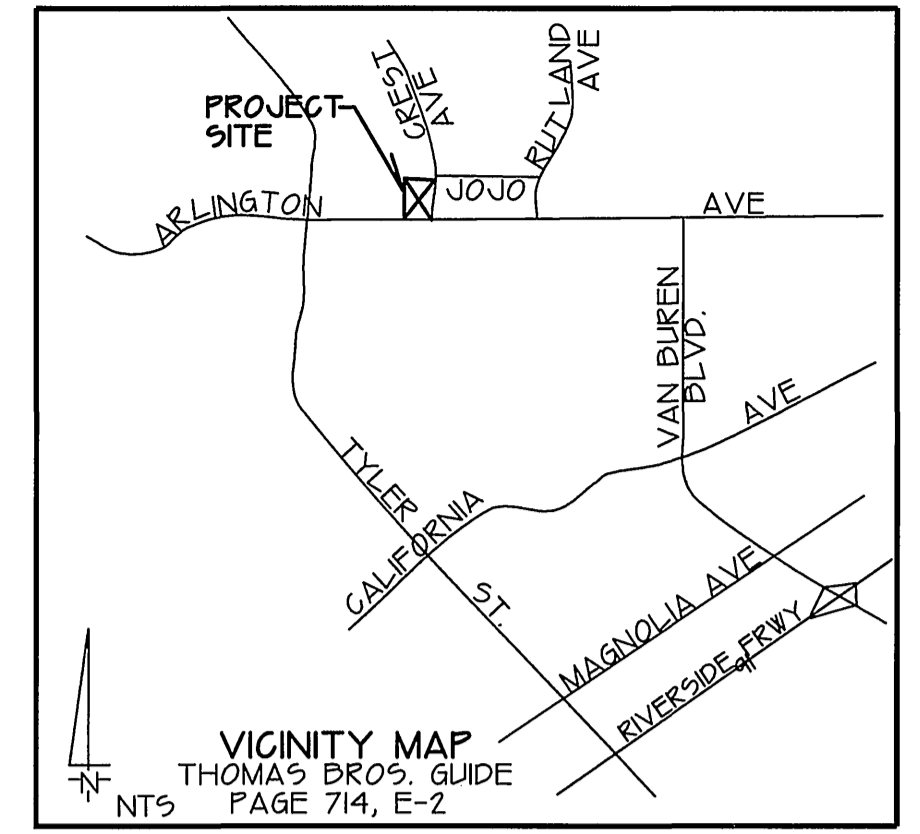

- CONSTRUCTION NOTES**
- (E) EXISTING SIGNAGE TO REMAIN
 - ① PAVEMENT MARKINGS PER CALTRANS STANDARDS
ALL PAVEMENT MARKINGS SHALL BE THERMOPLASTIC.
 - ② INSTALL CALTRANS 'NO PARKING' SIGN-R26 ON EXISTING POLE
 - ③ WET SANDBLAST CONFLICTING STRIPING REMOVE CONFLICTING RAISED PAVEMENT MARKERS.
 - ④ INSTALL 8" SOLID WHITE CHANNELIZING LINE PER CALTRANS STD.
 - ⑤ PAINT DOUBLE YELLOW STRIPE PER CALTRANS STD.
 - ⑥ INSTALL CALTRANS 'NO PARKING' SIGN-R26 TO EXISTING POLE.
 - ⑦ EXISTING 'NO PARKING DURING SCHOOL HOURS' TO BE REPLACED PER NOTE 2 ABOVE.

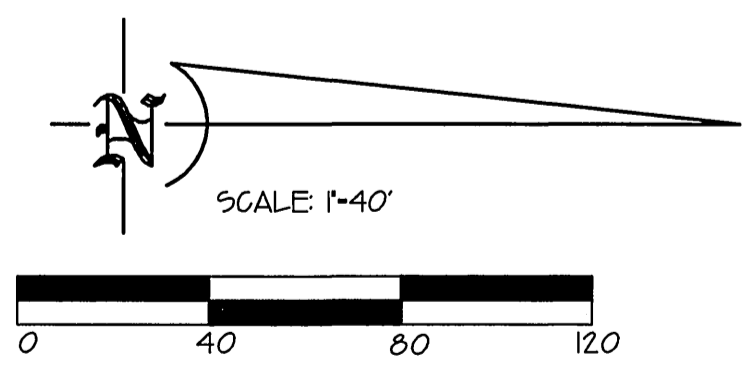

CITY OF RIVERSIDE PUBLIC UTILITIES DEPARTMENT-ELECTRIC OVERHEAD & UNDERGROUND	CITY OF RIVERSIDE WATER DEPT.
APPROVED BY _____ DATE _____	APPROVED BY _____ DATE _____

UNDERGROUND SERVICE ALERT

Call Toll FREE
1-800-227-2600

TWO WORKING DAYS BEFORE YOU DIG

*CAUTION: Remember that the USA Center locates only those utilities belonging to the center. There could be other utilities present at the work site. The center will inform you of whom they will notify.

PREPARED UNDER THE DIRECTION OF:

MELVIN W. THATCHER, III
R.C.E. NO. 34964
EXPIRATION DATE: 12-31-01 DATE: 5/12/00

THATCHER ENGINEERING & ASSOCIATES, INC.
94650 COUNTY LINE ROAD, STE. 4
YUCAIPA, CA. 92399
(909) 795-1410 FAX (909) 795-1400

Melvin W. Thatcher, III R.C.E. 39964 Exp. Dec 31, 2001

SCALE: 1"=40'
DATE: 5/12/00

CITY BUSINESS TAX CERT. NO. 059169
EXP. DATE: 6/1/00

DESIGNED BY: M.W.T.	DRAWN BY: G.H./J.V.	CHECKED BY: K.M.
MARK	REVISIONS	APPR. DATE

CITY OF RIVERSIDE, CALIFORNIA
DEPARTMENT OF PUBLIC WORKS

APPROVED BY	BY DATE
PRINCIPAL ENGR.	<i>R. McGrath</i> 7/13/00
PARK DEPARTMENT	
TRAFFIC DIVISION	
P.W. ENGR. MANAGER	

DATE 7-13-00

IN THE CITY OF RIVERSIDE
SIGNING & STRIPING PLANS
CREST STREET
STA. 0+00 TO 5+39
(NORTH OF ARLINGTON AVENUE)

FOR: _____

PROJECT NO.
XL-446

SHEET 1 OF 1

FILE NO.