

**STRIPING & MARKING LEGEND**

- (A) 4" SKIP WHITE STRIPE W/ MARKERS (SEE CALTRANS STD. PLAN A20A, DETAIL 12)
- (B) 4" SOLID WHITE STRIPE (SEE CALTRANS STD. PLAN A20B, DETAIL 27B)
- (C) 4" SOLID YELLOW STRIPE W/ MARKERS (SEE CALTRANS STD. PLAN A20B, DETAIL 25)
- (D) 4" SOLID DOUBLE YELLOW STRIPE W/ MARKERS (SEE CALTRANS STD. PLAN A20B, DETAIL 27)
- (E) 8" SOLID WHITE STRIPE W/ MARKERS (SEE CALTRANS STD. PLAN A20D, DETAIL 38)
- (F) 12" SOLID WHITE MARKING (SEE CALTRANS STD. PLAN A24E)
- (G) TYPE IV ARROW MARKING (SEE CALTRANS STD. PLAN A24A)
- (H) W1/W6(45) AND POST PER CITY OF RIVERSIDE STD. DWG. NO. 666.

**ENGINEER IN RESPONSIBLE CHARGE**  
 FRANCIS R. DUNASKI  
 T.R. No. 1569 expires 06/30/2001  
 DATE 7/6/11

MARK	REVISIONS	APPR.	DATE

CITY OF RIVERSIDE, CALIFORNIA DEPARTMENT OF PUBLIC WORKS			
APPROVED BY	BY	DATE	APPROVED BY
DEPUTY P.W. DIR./ENG.	DRS	7/9/11	R. M. Butt
PRINCIPAL ENGINEER		7/9/11	DIRECTOR OF PUBLIC WORKS
P.W. INSPECTION		7/9/11	
TRAFFIC DIVISION		7/6/11	
PUBLIC UTILITIES			

**STRIPING & SIGNING PLAN**  
 VAN BUREN BOULEVARD  
 900' S/O DUFFERIN AVENUE TO  
 MOCKINGBIRD CANYON ROAD  
 VAN BUREN BLVD. MEDIAN BARRIER

ACCT. NO.  
9538930214-44030200  
**XL-455**  
 SHEET 1 OF 2  
 FILE NAME: XL455-1.DWG

SCALE: 1" = 40'

DESIGNED BY: MAC DRAWN BY: MAC CHECKED BY: \_\_\_\_\_

DATE 7-10-2001

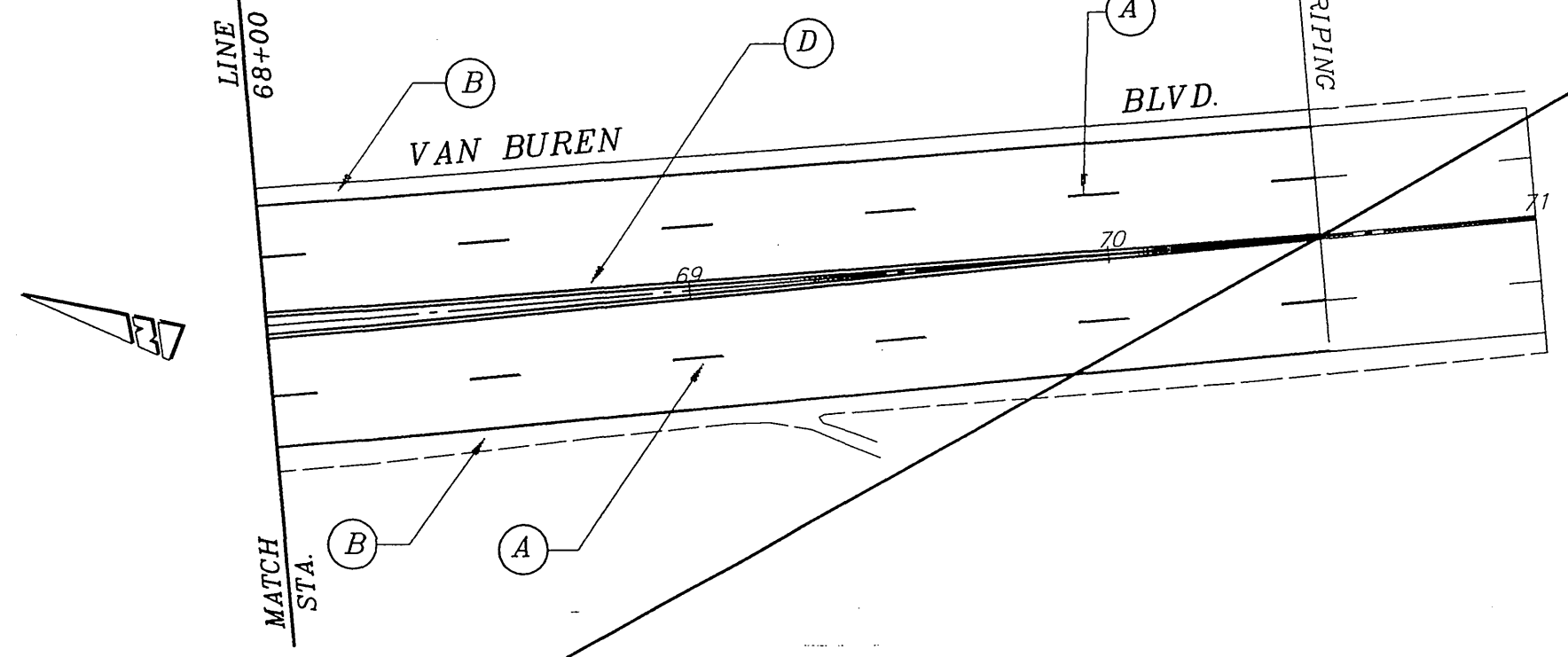
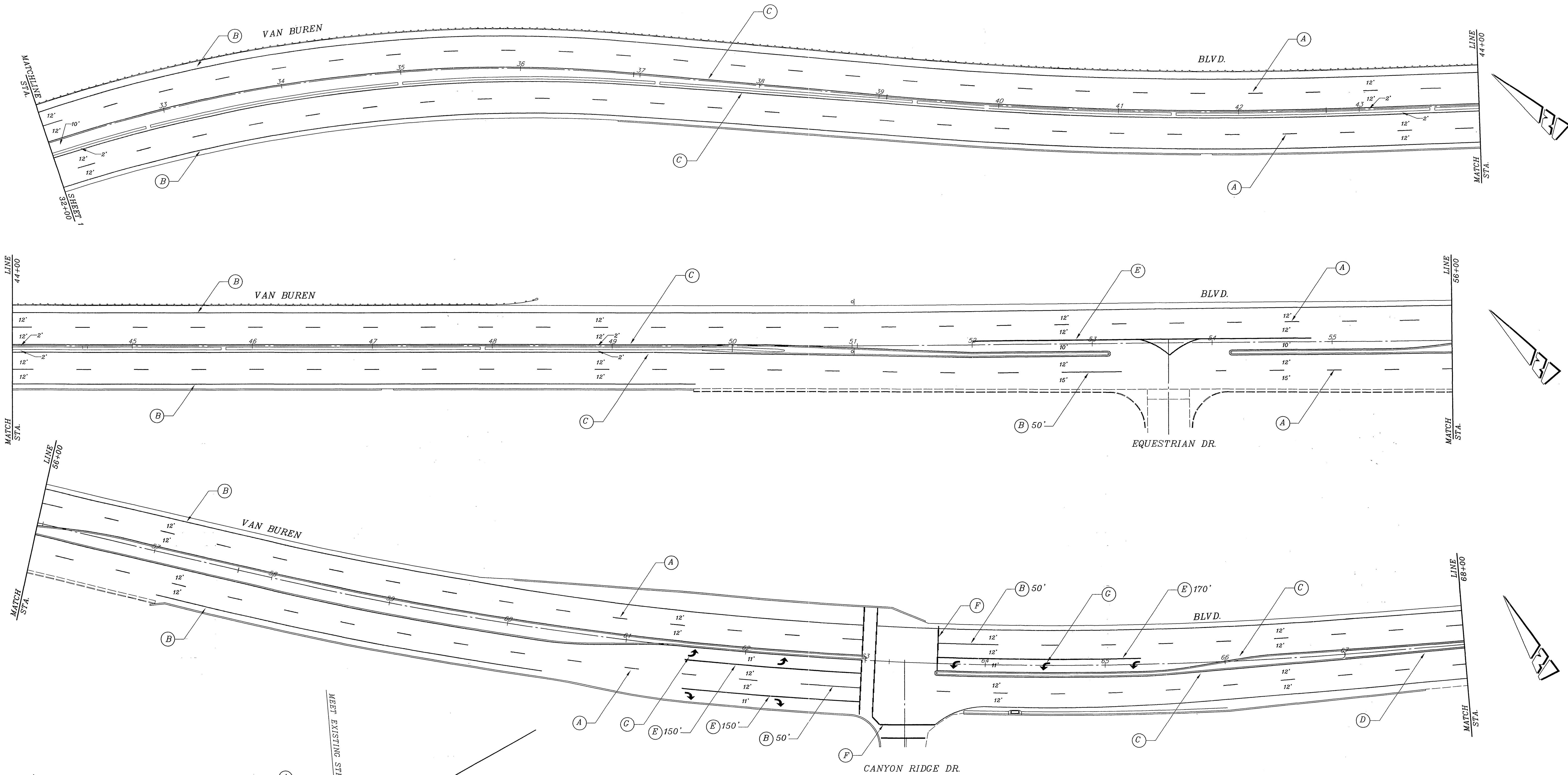

- STRIPING & MARKING LEGEND**
- (A) 4" SKIP WHITE STRIPE W/ MARKERS (SEE CALTRANS STD. PLAN A20A, DETAIL 12)
  - (B) 4" SOLID WHITE STRIPE (SEE CALTRANS STD. PLAN A20B, DETAIL 27B)
  - (C) 4" SOLID YELLOW STRIPE W/ MARKERS (SEE CALTRANS STD. PLAN A20B, DETAIL 25)
  - (D) 4" SOLID DOUBLE YELLOW STRIPE W/ MARKERS (SEE CALTRANS STD. PLAN A20B, DETAIL 27)
  - (E) 8" SOLID WHITE STRIPE W/ MARKERS (SEE CALTRANS STD. PLAN A20D, DETAIL 3B)
  - (F) 12" SOLID WHITE MARKING (SEE CALTRANS STD. PLAN A24E)
  - (G) TYPE IV ARROW MARKING (SEE CALTRANS STD. PLAN A24A)

**ENGINEER IN RESPONSIBLE CHARGE**  
  
 FRANCIS R. DINAFSKI  
 T.R. No. 1569 expires 06/30/2001  
 DATE 7/6/11

MARK	REVISIONS	APPR.	DATE

**CITY OF RIVERSIDE, CALIFORNIA  
 DEPARTMENT OF PUBLIC WORKS**

APPROVED BY	BY	DATE	APPROVED BY
DEPUTY P.W. DIR./ENGR.	7/6/11	7/6/11	R. McSwartz
PRINCIPAL ENGINEER	7/6/11	7/6/11	DIRECTOR OF PUBLIC WORKS
P.W. INSPECTION	7/6/11	7/6/11	
TRAFFIC DIVISION	7/6/11	7/6/11	
PUBLIC UTILITIES			

DESIGNED BY: MAC DRAWN BY: MAC CHECKED BY:  

**STRIPING & SIGNING PLAN**  
**VAN BUREN BOULEVARD**  
 900' S/O DUFFERIN AVENUE TO  
 MOCKINGBIRD CANYON ROAD  
**VAN BUREN BLVD. MEDIAN BARRIER**

ACCT. NO.  
 9538930214-44030200  
**XL-455**  
 SHEET 2 OF 2  
 FILE NAME: XL455-2A.DWG

SCALE: 1" = 40'