

**SIGNING AND STRIPING NOTES:**

1. TRAFFIC STRIPING, PAVEMENT MARKINGS AND RAISED PAVEMENT MARKERS PER CALTRANS TRAFFIC MANUAL, MAINTENANCE MANUAL, STD. PLANS AND SPECIFICATIONS, LATEST EDITIONS.
2. ALL STRIPES, SIGNS AND PAVEMENT MARKINGS SHALL BE REFLECTORIZED. STENCILS FOR PAVEMENT MARKINGS SHALL MATCH CITY OF RIVERSIDE STENCILS.
3. ALL CONFLICTING STRIPES AND PAVEMENT MARKINGS SHALL BE REMOVED BY WET SANDBLASTING. CONFLICTING SIGN AND RAISED PAVEMENT MARKERS SHALL BE REMOVED. ALL REMOVALS SHALL BE THE RESPONSIBILITY OF THE DEVELOPER.
4. ALL STRIPES SHALL BE APPLIED IN TWO COATS.
5. ALL REMOVED SIGNS SHALL BE SALVAGED AND DELIVERED TO THE CITY YARD.
6. ALL PAVEMENT MARKINGS AND LEGENDS SHALL BE THERMOPLASTIC
7. ALL STRIPING, PAVEMENT MARKINGS AND SIGN REQUIREMENTS (REMOVALS AND INSTALLATIONS) SHALL BE COMPLETED AT LEAST ONE DAY PRIOR TO TRAFFIC SIGNAL TURN ON.

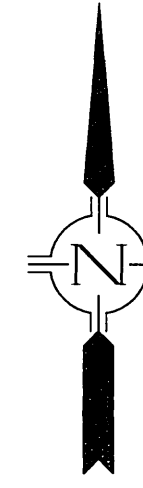

**LEGEND**

- ⊕ INSTALL STRIPING DETAIL PER CALTRANS STD. PLAN A20A-A20D
- ⊖ EXIST. STRIPING DETAIL PER CALTRANS STD. PLAN A20A-A20D TO REMAIN UNLESS OTHERWISE NOTED.
- 1 INSTALL 12" SOLID WHITE (CROSSWALK OR STOP BAR)
- 2 DELETED
- 3 PAINT MEDIAN NOSE REFLECTIVE YELLOW
- 4 INSTALL "STOP" PAVEMENT MARKING
- RL RELOCATE EXIST SIGN AND POST
- RM REMOVE EXIST. MARKING OR STRIPING
- RP REPAINT EXIST. MARKING OR STRIPING
- ↩ INSTALL TYPE IV (L OR R) ARROW MARKING.
- INSTALL SIGN (AS SHOWN) & POST
- EXISTING SIGN (AS SHOWN) & POST TO BE REMAIN UNLESS OTHERWISE NOTED.

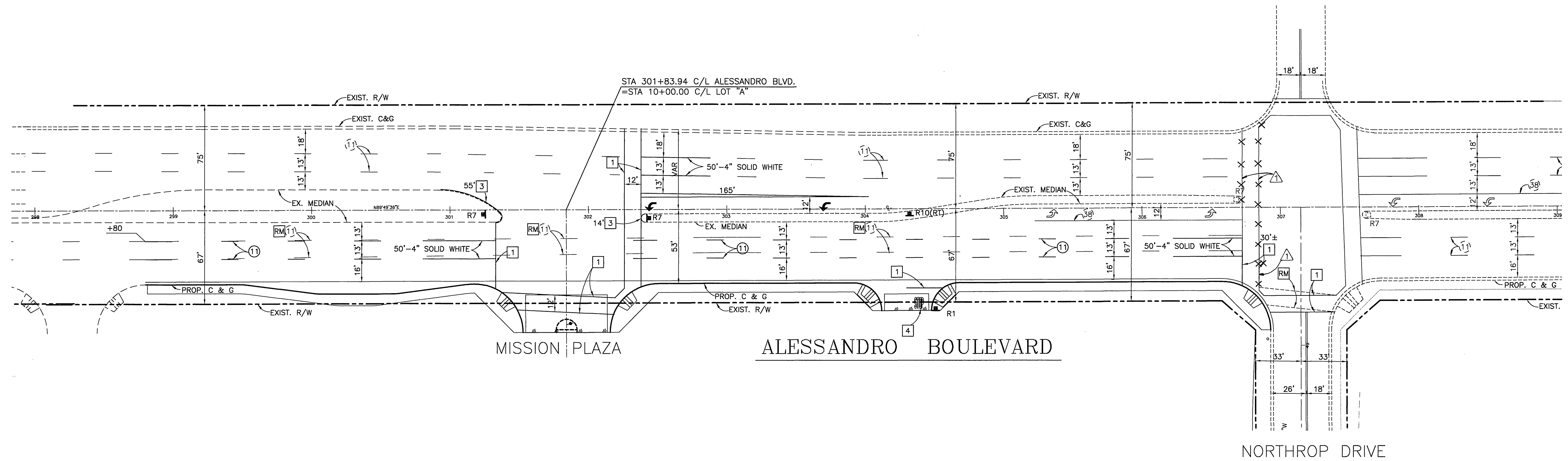

Underground Service Alert  
Call: TOLL FREE  
1 - 800  
227-2600  
TWO WORKING DAYS BEFORE YOU DIG

**PRIVATE ENGINEERING NOTE**  
CONSTRUCTION CONTRACTOR AGREES THAT IN ACCORDANCE WITH GENERALLY ACCEPTED CONSTRUCTION PRACTICES, CONSTRUCTION CONTRACTOR WILL BE REQUIRED TO ASSUME SOLE AND COMPLETE RESPONSIBILITY FOR JOB SITE CONDITIONS DURING THE COURSE OF CONSTRUCTION OF THE PROJECT, INCLUDING SAFETY OF ALL PERSONS AND PROPERTY. THAT THIS REQUIREMENT SHALL BE MADE TO APPLY CONTINUOUSLY AND NOT BE LIMITED TO NORMAL WORKING HOURS, AND HOLD DESIGN PROFESSIONAL HARMLESS FROM ANY AND ALL LIABILITY, REAL OR ALLEGED, IN CONNECTION WITH THE PERFORMANCE OF WORK ON THIS PROJECT, EXCEPTING LIABILITY ARISING FROM THE SOLE NEGLIGENCE OF DESIGN PROFESSIONAL.

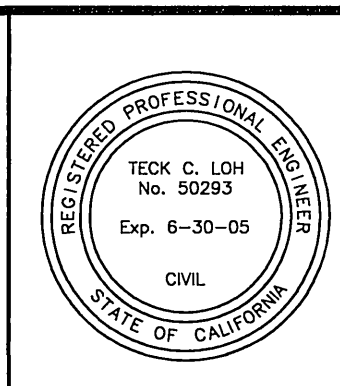

PREPARED UNDER THE DIRECTION OF:  
*Teck C. Loh*  
TECK C. LOH  
REGISTERED CIVIL ENGINEER NO. 50293  
EXPIRATION DATE: 6-30-05 DATE: 1/25/02

**CEG** CANTY ENGINEERING GROUP, INC.  
CIVIL ENGINEERING - PLANNING - SURVEYING  
2020 IOWA AVENUE, SUITE A-102, P.O. BOX 52050, RIVERSIDE, CA 92517  
TEL (909) 683 - 5234 FAX (909) 683 - 5301  
SCALE: 1" = 40' BENCH MARK:  
DATE: JANUARY 2002

|  |                  |
|--|------------------|
| REVISIONS                                  | DATE             |
| REMOVE CROSSWALK TO MATCH EXIST. CONDITION | 9/17/02          |
| DESIGNED BY: K.T.O.                        | DRAWN BY: K.T.O. |
| CHECKED BY: T.L.                           |                  |

|   |         |
|---|---------|
| CITY OF RIVERSIDE, CALIFORNIA<br>DEPARTMENT OF PUBLIC WORKS |         |
| APPROVED BY:  | DATE:   |
| PRINCIPAL ENGR. <i>De Wilson</i>                            | 9/17/02 |
| PARK DEPARTMENT   |         |
| TRAFFIC DIVISION  | 1/25/02 |
| P.W. ENGINEER, MGR.   |         |
| STREET SERVICES   | 1/25/02 |
| APPROVED BY:  | DATE:   |
| <i>Thom Boyd</i>  | 2/4/02  |
| DIRECTOR OF PUBLIC WORKS                                    |         |

MISSION VILLAGE PLAZA  
SIGNING AND STRIPING PLAN  
ALESSANDRO BLVD.  
298+80 TO 307+00.00  
FOR: REGIONAL PROPERTIES

PROJECT NO.  
**XL-460**  
SHEET 1 OF 1  
FILE NO.: 1004-016