

SYCAMORE CANYON BLVD. STRIPING PLAN

SIGNING AND STRIPING GENERAL NOTES

- ALL ITEMS TO BE FURNISHED AND ALL WORK TO BE DONE SHALL CONFORM TO THE REQUIREMENTS OF THE STATE OF CALIFORNIA, DEPARTMENT OF TRANSPORTATION (CALTRANS) STANDARD PLANS (DATED JULY 1999) AND SPECIFICATIONS (DATED JULY 1999); CALTRANS TRAFFIC MANUAL (DATED NOVEMBER 1996); THE SPECIAL ROVISIONS; OR AS DIRECTED BY THE STATE REPRESENTATIVE.
- ALL REQUIRED MATERIAL AND EQUIPMENT SHALL BE FURNISHED AND INSTALL BY CONTRACTOR.
- CONTRACTOR TO REMOVE ALL CONFLICTING STRIPING AND PAVEMENT MARKINGS. PAINTED STRIPING AND PAVEMENT MARKINGS SHALL BE REMOVED BY SANDBLASTING. THERMOPLASTIC STRIPING AND PAVEMENT MARKINGS SHALL BE REMOVED BY SURFACE ABRADING. REMOVAL LIMITS SHALL EXCEED STRIPING AND PAVEMENTS AND LEGEND EDGES TO ELIMINATE SHADOWING.
- TRAFFIC SIGNS, STRIPING AND LEGENDS SHALL BE PER CALTRANS TRAFFIC SIGN SPECIFICATIONS, TRAFFIC MANUAL AND STANDARD SPECIFICATIONS.
- SIGNS SHALL BE STANDARD SIZE UNLESS OTHERWISE NOTED ON PLANS.
- PAINTED TRAFFIC STRIPES AND PAINTED PAVEMENT MARKINGS (IF ALLOWED) SHALL BE APPLIED IN TWO COATS. PAVEMENT MARKINGS SHALL BE APPLIED IN THERMOPLASTIC FORMAT UNLESS APPROVED OTHERWISE.

CONSTRUCTION NOTES

- EX EXISTING TO REMAIN
- SB SANDBLAST CONFLICTING STRIPING. REMOVE EXISTING CONFLICTING REFLECTIVE PAVEMENT MARKERS.
- ① INSTALL STANDARD SIZE SIGN AS INDICATED PER CALTRANS TRAFFIC MANUAL, CHAPTER 4.
- ② PAINT 4" / 4" DOUBLE YELLOW STRIPE PER CALTRANS STANDARD PLANS, PLAN NO. A20A, DETAIL 22
- ③ APPLY THERMOPLASTIC 12" SOLID WHITE STRIPE PER CALTRANS STANDARD PLAN NO A24E
- ④ APPLY THERMOPLASTIC "SIGNAL AHEAD" LEGEND PER CALTRANS STANDARD PLAN NO. A24D
- ⑤ PAINT 8" SOLID WHITE STRIPE PER CALTRANS STANDARD PLANS, PLAN NO. A20D, DETAIL 38
- ⑥ APPLY THERMOPLASTIC ARROW MARKING PER CALTRANS STANDARD PLAN NO A24A
- ⑦ DELINEATOR AS PER STREET IMPROVEMENT PLANS.
- ⑧ PAINT MEDIAN ISLAND PER CALTRANS STANDARD PLANS, PLAN NO. A20B, DETAIL 32
- ⑨ PAINT 4" SOLID WHITE STRIPE PER CALTRANS STANDARD PLANS, PLAN NO. A20B, DETAIL 27B
- ⑩ APPLY THERMOPLASTIC "STOP" LEGEND PER CALTRANS STANDARD PLAN NO. A24D

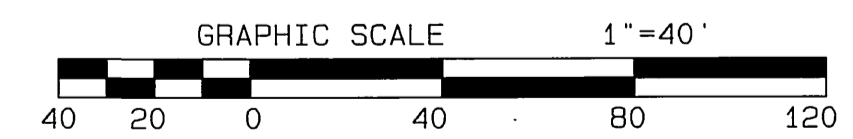
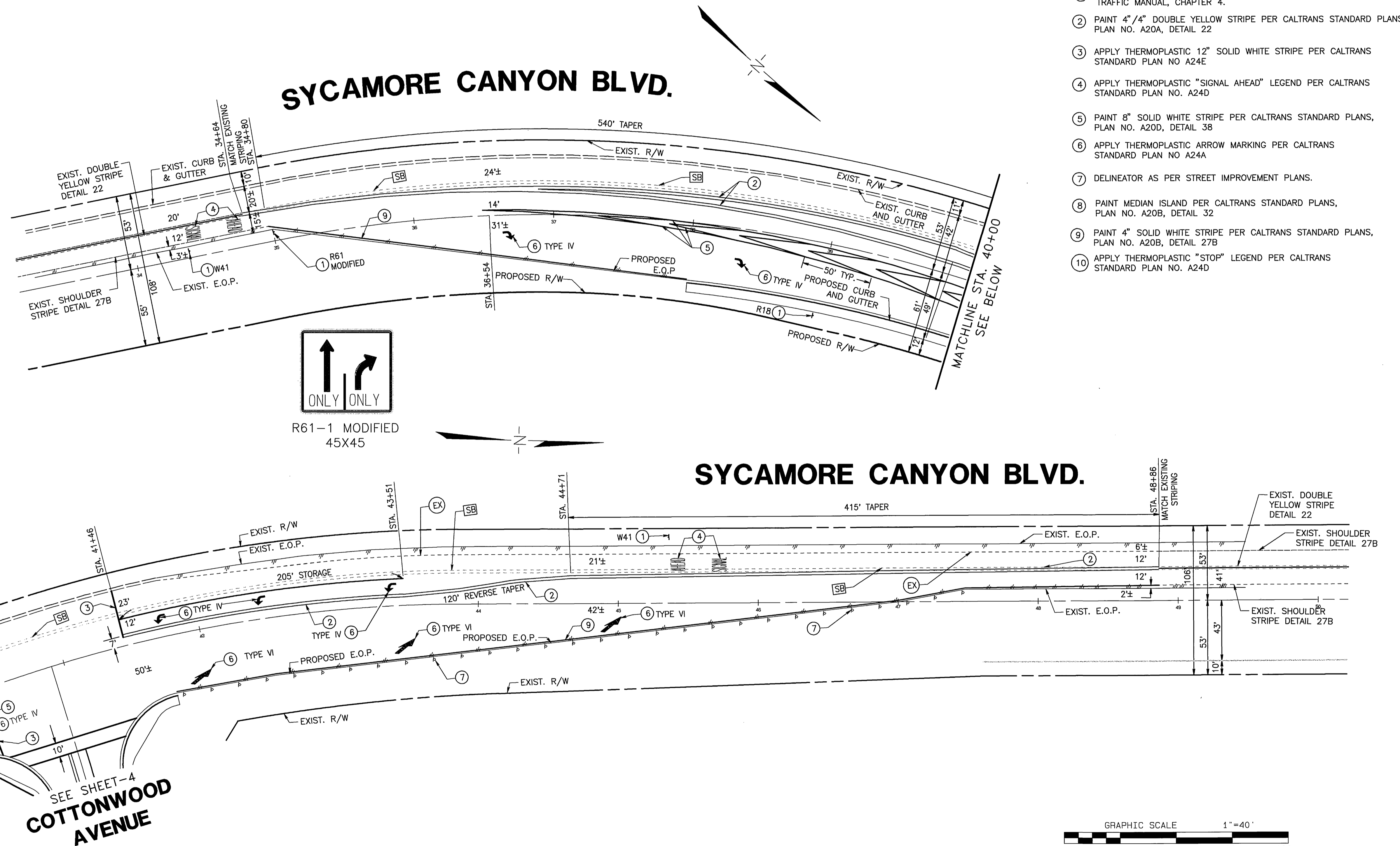

BENCH MARK P.K. NAIL AND CITY ENGINEER TAGGED "L1-C3" IN NORTHERLY CORNER OF CATCH BASIN IN THE MEDIAN CURB OF SYCAMORE CANYON BLVD., 95 FEET SOUTHERLY OF FAIR ISLE DRIVE. ELEV.= 1510.379		ALBERT A. WEBB ASSOCIATES CIVIL ENGINEERS 3788 McCRAV ST. RIVERSIDE, CA. 92506 PH: (909) 686-1070 FAX: (909) 788-1256 APPROVED BY: <i>[Signature]</i> DATE: 6/12/02 R.C.E. NO. C44762	CITY BUSINESS TAX CERTIFICATE NO. 005751 EXP. 12-31-02		CITY OF RIVERSIDE, CALIFORNIA PUBLIC WORKS DEPARTMENT APPROVED BY: <i>[Signature]</i> DATE: 6/12/02 PRINCIPAL ENGINEER TRAFFIC DIVISION STREET SERVICES P.W. ENG. MGR.		SIGNING AND STRIPING PLAN STRIPING PLAN, GENERAL NOTES, CONSTRUCTION NOTES SYCAMORE CANYON BLVD. SCALE: 1" = 40'		ACCOUNT NO. DRAWING NUMBER XL-462 SHEET 1 OF 2 01322TS.PRO
			W.O. 01-0322 FOR: THE CITY OF RIVERSIDE	DESIGNED BY: D.S. CHECKED BY: S.H. PLN CHK REF	DATE: 6/12/02	DATE: 6/12/02			

COTTONWOOD AVENUE STRIPING PLAN

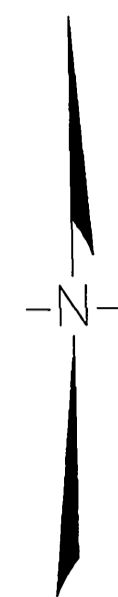

CONSTRUCTION NOTES

- EX EXISTING TO REMAIN
- SB SANDBLAST CONFLICTING STRIPING. REMOVE EXISTING CONFLICTING REFLECTIVE PAVEMENT MARKERS.
- ① INSTALL STANDARD SIZE SIGN AS INDICATED PER CALTRANS TRAFFIC MANUAL, CHAPTER 4.
- ② PAINT 4" / 4" DOUBLE YELLOW STRIPE PER CALTRANS STANDARD PLANS, PLAN NO. A20A, DETAIL 22
- ③ APPLY THERMOPLASTIC 12" SOLID WHITE STRIPE PER CALTRANS STANDARD PLAN NO A24E
- ⑤ PAINT 8" SOLID WHITE STRIPE PER CALTRANS STANDARD PLANS, PLAN NO. A20D, DETAIL 38
- ⑥ APPLY THERMOPLASTIC ARROW MARKING PER CALTRANS STANDARD PLAN NO A24A
- ⑧ PAINT MEDIAN ISLAND PER CALTRANS STANDARD PLANS, PLAN NO. A20B, DETAIL 32
- ⑩ APPLY THERMOPLASTIC "STOP" LEGEND PER CALTRANS STANDARD PLAN NO. A24D

COTTONWOOD AVE.

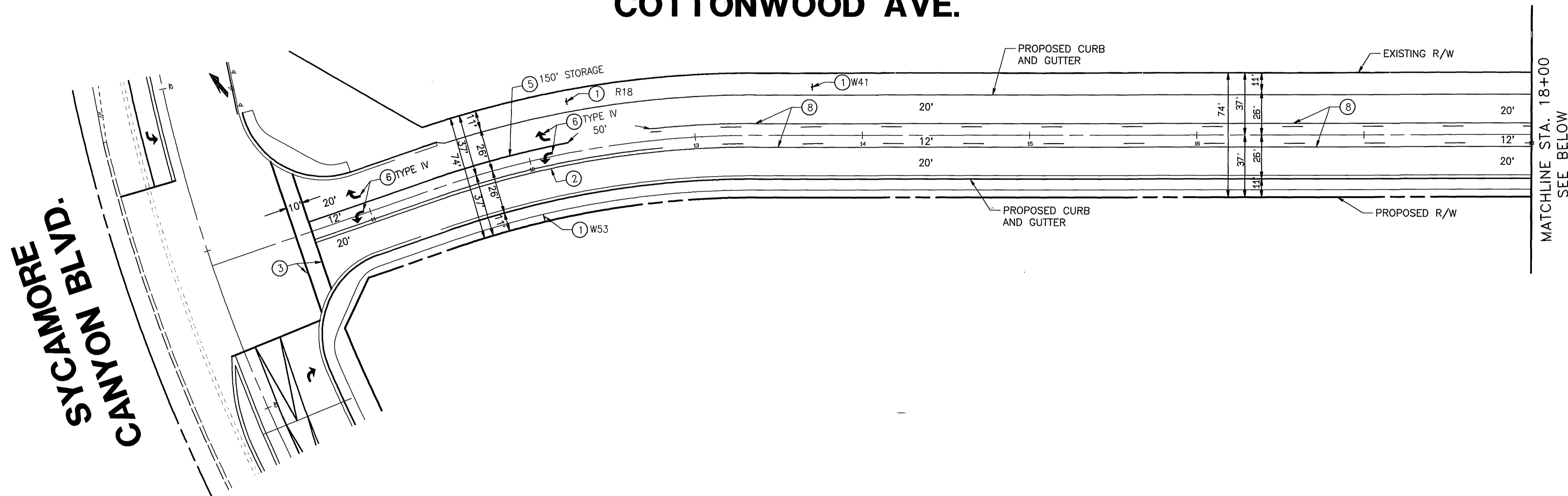

COTTONWOOD AVE.

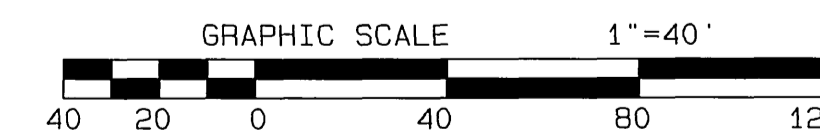
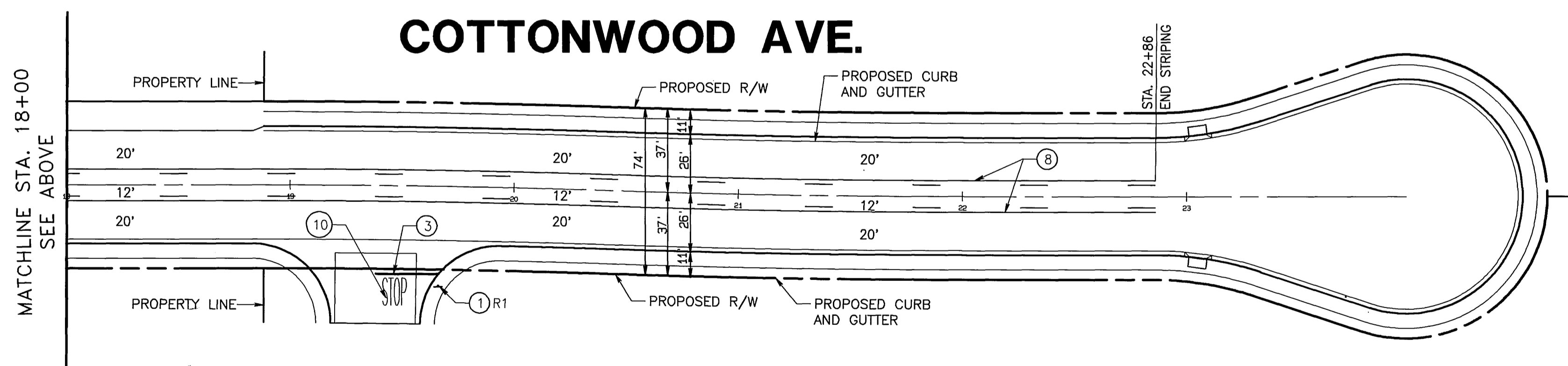

CITY BUSINESS TAX CERTIFICATE NO. 005751 EXP. 12-31-02

<p>BENCH MARK P.K. NAIL AND CITY ENGINEER TAGGED "L1-C3" IN NORTHERLY CORNER OF CATCH BASIN IN THE MEDIAN CURB OF SYCAMORE CANYON BLVD., 95 FEET SOUTHERLY OF FAIR ISLE DRIVE. ELEV.= 1510.379</p>		<p>ALBERT A. WEBB ASSOCIATE ENGINEER CONSULTANTS APPROVED BY: <i>[Signature]</i> DATE: 6-12-02 R.C.E. NO. C44762</p>	<p>CIVIL ENGINEERS 3788 McCRAY ST. RIVERSIDE, CA. 92506 PH: (909) 686-1070 FAX: (909) 788-1256</p>	<p>CITY OF RIVERSIDE, CALIFORNIA PUBLIC WORKS DEPARTMENT</p> <table border="1" style="width: 100%; border-collapse: collapse;"> <tr> <td>APPROVED BY</td> <td>BY DATE</td> <td>APPROVED BY</td> </tr> <tr> <td>PRINCIPAL ENGINEER</td> <td><i>[Signature]</i> 6/12/02</td> <td><i>[Signature]</i></td> </tr> <tr> <td>TRAFFIC DIVISION</td> <td>STREET SERVICES</td> <td>P.W. ENG. MGR.</td> </tr> </table>	APPROVED BY	BY DATE	APPROVED BY	PRINCIPAL ENGINEER	<i>[Signature]</i> 6/12/02	<i>[Signature]</i>	TRAFFIC DIVISION	STREET SERVICES	P.W. ENG. MGR.	<p>SIGNING AND STRIPING PLAN STRIPING PLAN, GENERAL NOTES, CONSTRUCTION NOTES SYCAMORE CANYON BLVD</p>	<p>ACCOUNT NO. DRAWING NUMBER XL-462 SHEET 2 OF 2 01322TS.PRO</p>
APPROVED BY	BY DATE	APPROVED BY													
PRINCIPAL ENGINEER	<i>[Signature]</i> 6/12/02	<i>[Signature]</i>													
TRAFFIC DIVISION	STREET SERVICES	P.W. ENG. MGR.													
		W.O. 01-0322 FOR THE CITY OF RIVERSIDE		DESIGNED BY: D.S. CHECKED BY: S.H. PLN CHK REF		SCALE: 1" = 40'									