

GENERAL STRIPING NOTES:

- 1 REMOVE ALL EXISTING R26 SIGNS AND BIKE LANE SIGNS ENTIRE PROJECT LIMITS AND REPLACE WITH DETAIL "A" SIGNS, HEREON.

SPECIFIC STRIPING NOTES:

- ST SW CONSTRUCT 4" SOLID WHITE LINE PER CALTRANS PLAN A20B, DETAIL 27B, PER LENGTH SPECIFIED BELOW NOTE.
- ST DL CONSTRUCT DASHED WHITE LANE STRIPING PER CALTRANS STANDARD PLAN A20A, DETAIL 9.
- ST BL CONSTRUCT BIKE LANE STRIPING PER CALTRANS STANDARD PLAN A20D, DETAILS 39 AND 39A.
- ST BK CONSTRUCT BIKE LANE SYMBOL PER CALTRANS STANDARD PLAN A24C.

SEE CITY OF RIVERSIDE PLAN NO. XL-493

MATCHLINE STA. 165+50 SEE BELOW

MATCHLINE STA. 165+50 SEE ABOVE

MATCHLINE STA. 178+00 SEE SHEET 2

SPECIFIC STRIPING NOTES CONT.:

- ST DY CONSTRUCT SOLID DOUBLE YELLOW LANE STRIPING PER CALTRANS STANDARD PLAN A20B, DETAIL 22.
- ST CW CONSTRUCT 12" SOLID WHITE CROSSWALK LINE PER CALTRANS STANDARD PLAN A24E.
- ST LT CONSTRUCT SOLID WHITE LEFT TURN LANE ARROW SYMBOL PER CALTRANS STANDARD PLAN A24A.
- ST RT CONSTRUCT SOLID WHITE RIGHT TURN LANE ARROW SYMBOL PER CALTRANS STANDARD PLAN A24A.
- ST SGN CONSTRUCT TRAFFIC SIGN, POST AND FOOTING PER CITY OF RIVERSIDE STANDARDS, AND AS SHOWN.
- ST TL CONSTRUCT 8" SOLID WHITE LINE PER CALTRANS PLAN A20B, DETAIL 27B, PER LENGTH SPECIFIED BELOW NOTE.

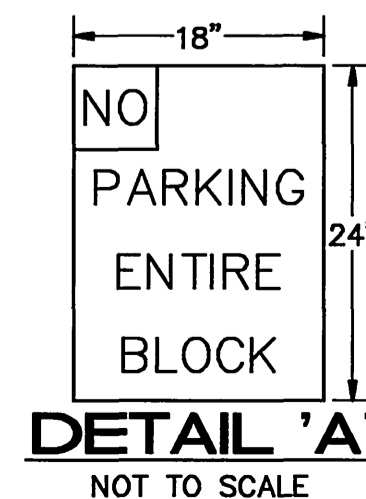

Underground Service Alert
SECTION 4216/4217 OF THE GOVERNMENT CODE REQUIRES A DIG ALERT IDENTIFICATION NUMBER BE ISSUED BEFORE A PERMIT TO EXCAVATE WILL BE VALID
FOR YOUR DIG ALERT I.D. NUMBER CALL UNDERGROUND SERVICE ALERT
TOLL FREE 1-800-227-2600
TWO WORKING DAYS BEFORE YOU DIG

CLIENT: CITY OF RIVERSIDE
TWE JOB # 108-06

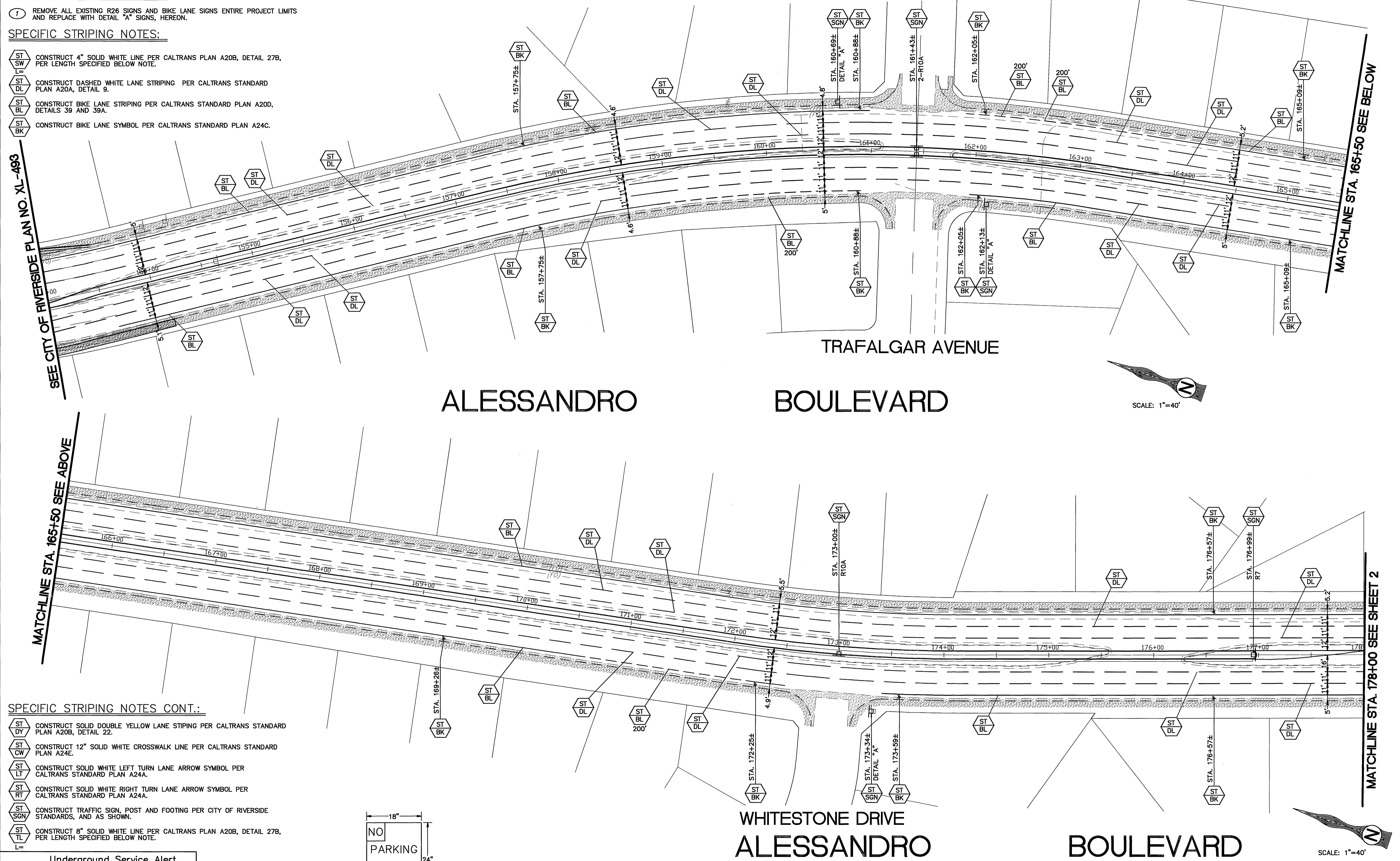

TKE ENGINEERING
TKE ENGINEERING, INC.
4446 CENTRAL AVENUE
RIVERSIDE, CA 92506
(951) 680-0440
FAX (951) 680-0490
MICHAEL PATRICK THORNTON R.C.E. No. 44226
EXPIRES: 6-30-07

PROFESSIONAL ENGINEER
MICHAEL P. THORNTON
No. 44226
Exp. 6-30-07
CIVIL
STATE OF CALIFORNIA

CITY OF RIVERSIDE, CALIFORNIA
PUBLIC WORKS DEPARTMENT

APPROVED BY:	DATE:
PRINCIPAL ENGINEER	4/18/06
CONST. CONTRACT ADMIN.	
STREET SERVICES	
SURVEYOR	
TRAFFIC DIVISION	

STRIPING AND SIGNING IMPROVEMENT PLANS
ALESSANDRO BOULEVARD
ARLINGTON AVENUE/TRAUTWEIN ROAD

ACCT. NO.
XL-509
SHEET **1** OF **6**
HORIZ. SCALE: 1" = 40' VERT. SCALE: 1/4"

CENTURY AVENUE

EL PORTAL

MATCHLINE STA. 178+00 SEE SHEET 1

MATCHLINE STA. 190+50 SEE BELOW

MATCHLINE STA. 190+50 SEE ABOVE

MATCHLINE STA. 203+00 SEE SHEET 3

ALESSANDRO BOULEVARD

SCALE: 1"=40'

ALESSANDRO BOULEVARD

SCALE: 1"=40'

Underground Service Alert

SECTION 4216/4217 OF THE GOVERNMENT CODE REQUIRES A DIG ALERT IDENTIFICATION NUMBER BE ISSUED BEFORE A PERMIT TO EXCAVATE WILL BE VALID FOR YOUR DIG ALERT I.D. NUMBER CALL UNDERGROUND SERVICE ALERT TOLL FREE 1-800-227-2600 TWO WORKING DAYS BEFORE YOU DIG



CLIENT: CITY OF RIVERSIDE
TKE # 108-02

TKE ENGINEERING, INC.
4446 CENTRAL AVENUE
RIVERSIDE, CA 92506
(951) 680-0440
FAX (951) 680-0490

Michael P. Thornton
MICHAEL PATRICK THORNTON R.C.E. No. 44226
EXPIRES: 6-30-07

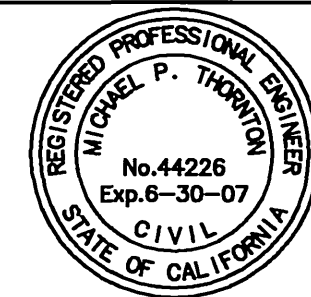

NO.	REVISIONS	APPR.	DATE

DESIGNED BY: *TMR* DRAWN BY: *CAB* CHECKED BY: *MPT*

CITY OF RIVERSIDE, CALIFORNIA PUBLIC WORKS DEPARTMENT			
APPROVED BY:	BY:	DATE:	APPROVED BY:
	<i>[Signature]</i>	4/18/06	<i>[Signature]</i>

**STRIPING AND SIGNING
IMPROVEMENT PLANS**

ALESSANDRO BOULEVARD
ARLINGTON AVENUE/TRAUTWEIN ROAD

HORIZ. SCALE: 1" = 40' VERT. SCALE: 1/4"

ACCT. NO.
XL-509

SHEET **2** OF **6**

HAWKLEY DRIVE

MATCHLINE STA. 203+00 SEE SHEET 2

MATCHLINE STA. 215+50 SEE BELOW

ALESSANDRO BOULEVARD

SCALE: 1"=40'

MATCHLINE STA. 215+50 SEE ABOVE

MATCHLINE STA. 227+50 SEE SHEET 4

ALESSANDRO BOULEVARD

SCALE: 1"=40'

Underground Service Alert
SECTION 4216/4217 OF THE GOVERNMENT CODE REQUIRES A DIG ALERT IDENTIFICATION NUMBER BE ISSUED BEFORE A PERMIT TO EXCAVATE WILL BE VALID
FOR YOUR DIG ALERT I.D. NUMBER CALL UNDERGROUND SERVICE ALERT TOLL FREE 1-800-227-2600 TWO WORKING DAYS BEFORE YOU DIG



TKE ENGINEERING, INC.
4446 CENTRAL AVENUE
RIVERSIDE, CA 92506
(951) 680-0440
FAX (951) 680-0490
Michael P. Thornton 4/18/06
MICHAEL PATRICK THORNTON R.C.E. No. 44226
EXPIRES: 6-30-07



CITY OF RIVERSIDE, CALIFORNIA
PUBLIC WORKS DEPARTMENT

APPROVED BY: [Signature]
DATE: 4/18/06
DESIGNED BY: TMR
DRAWN BY: CAB
CHECKED BY: MPT

STRIPING AND SIGNING
IMPROVEMENT PLANS
ALESSANDRO BOULEVARD
ARLINGTON AVENUE/TRAUTWEIN ROAD

ACCT. NO.
XL-509
SHEET 3 OF 6

HORIZ. SCALE: 1" = 40' VERT. SCALE: N/A

MATCHLINE STA. 227+00 SEE SHEET 3

MATCHLINE STA. 240+00 SEE BELOW

CANYON CREST DRIVE

ALESSANDRO BOULEVARD

SCALE: 1"=40'

MATCHLINE STA. 240+00 SEE ABOVE

MATCHLINE STA. 252+00 SEE SHEET 5

CANNON ROAD

ALESSANDRO BOULEVARD

SCALE: 1"=40'

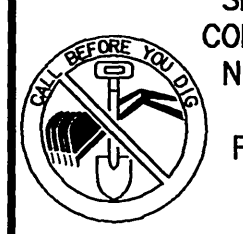

Underground Service Alert
 SECTION 4216/4217 OF THE GOVERNMENT CODE REQUIRES A DIG ALERT IDENTIFICATION NUMBER BE ISSUED BEFORE A PERMIT TO EXCAVATE WILL BE VALID
 FOR YOUR DIG ALERT I.D. NUMBER CALL UNDERGROUND SERVICE ALERT TOLL FREE 1-800-227-2600
 TWO WORKING DAYS BEFORE YOU DIG

TKE ENGINEERING
 TKE ENGINEERING, INC.
 4446 CENTRAL AVENUE
 RIVERSIDE, CA 92506
 (951) 680-0440
 FAX (951) 680-0490
 MICHAEL PATRICK THORNTON R.C.E. No. 44226
 EXPIRES: 6-30-07



DESIGNED BY: <i>TMR</i>	DRAWN BY: <i>CAB</i>	CHECKED BY: <i>MPT</i>
-------------------------	----------------------	------------------------

CITY OF RIVERSIDE, CALIFORNIA PUBLIC WORKS DEPARTMENT	
APPROVED BY: <i>[Signature]</i>	DATE: <i>4/18/06</i>
PRINCIPAL ENGINEER	CITY ENGINEER
CONTRACT ADMIN.	
STREET SERVICES	
SURVEYOR	
TRAFFIC ENGINEER	

STRIPING AND SIGNING IMPROVEMENT PLANS
 ALESSANDRO BOULEVARD
 ARLINGTON AVENUE/TRAUTWEIN ROAD
 HORIZ. SCALE: 1" = 40' VERT. SCALE: N/A

ACCT. NO. **XL-509**
 SHEET **4** OF **6**

MATCHLINE STA. 252+00 SEE SHEET 4

MATCHLINE STA. 264+00 SEE BELOW

ALESSANDRO BOULEVARD

COMMUNICATION CTR. DRIVE

SCALE: 1"=40'

MATCHLINE SEE SHEET 5

ALESSANDRO BOULEVARD

TRAUTWEIN ROAD

SCALE: 1"=40'

Underground Service Alert
 SECTION 4216/4217 OF THE GOVERNMENT CODE REQUIRES A DIG ALERT IDENTIFICATION NUMBER BE ISSUED BEFORE A PERMIT TO EXCAVATE WILL BE VALID
 FOR YOUR DIG ALERT I.D. NUMBER CALL UNDERGROUND SERVICE ALERT TOLL FREE 1-800-227-2600 TWO WORKING DAYS BEFORE YOU DIG

TKE ENGINEERING, INC.
 4446 CENTRAL AVENUE
 RIVERSIDE, CA 92506
 (951) 680-0440
 FAX (951) 680-0490

Michael P. Thornton 4/18/06
 MICHAEL PATRICK THORNTON R.C.E. No. 44226
 EXPIRES: 6-30-07

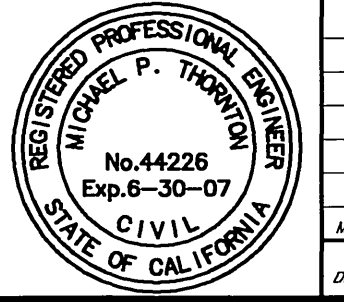

NO.	REVISIONS	APPR.	DATE

CITY OF RIVERSIDE, CALIFORNIA
 PUBLIC WORKS DEPARTMENT

APPROVED BY: *[Signature]* DATE: 4/18/06
 SUPERVISOR: *[Signature]* DATE: 4/18/06

STRIPING AND SIGNING IMPROVEMENT PLANS
 ALESSANDRO BOULEVARD
 ARLINGTON AVENUE/TRAUTWEIN ROAD

ACCT. NO. XL-509
 SHEET 5 OF 6

HORIZ. SCALE: 1" = 40' VERT. SCALE: N/A

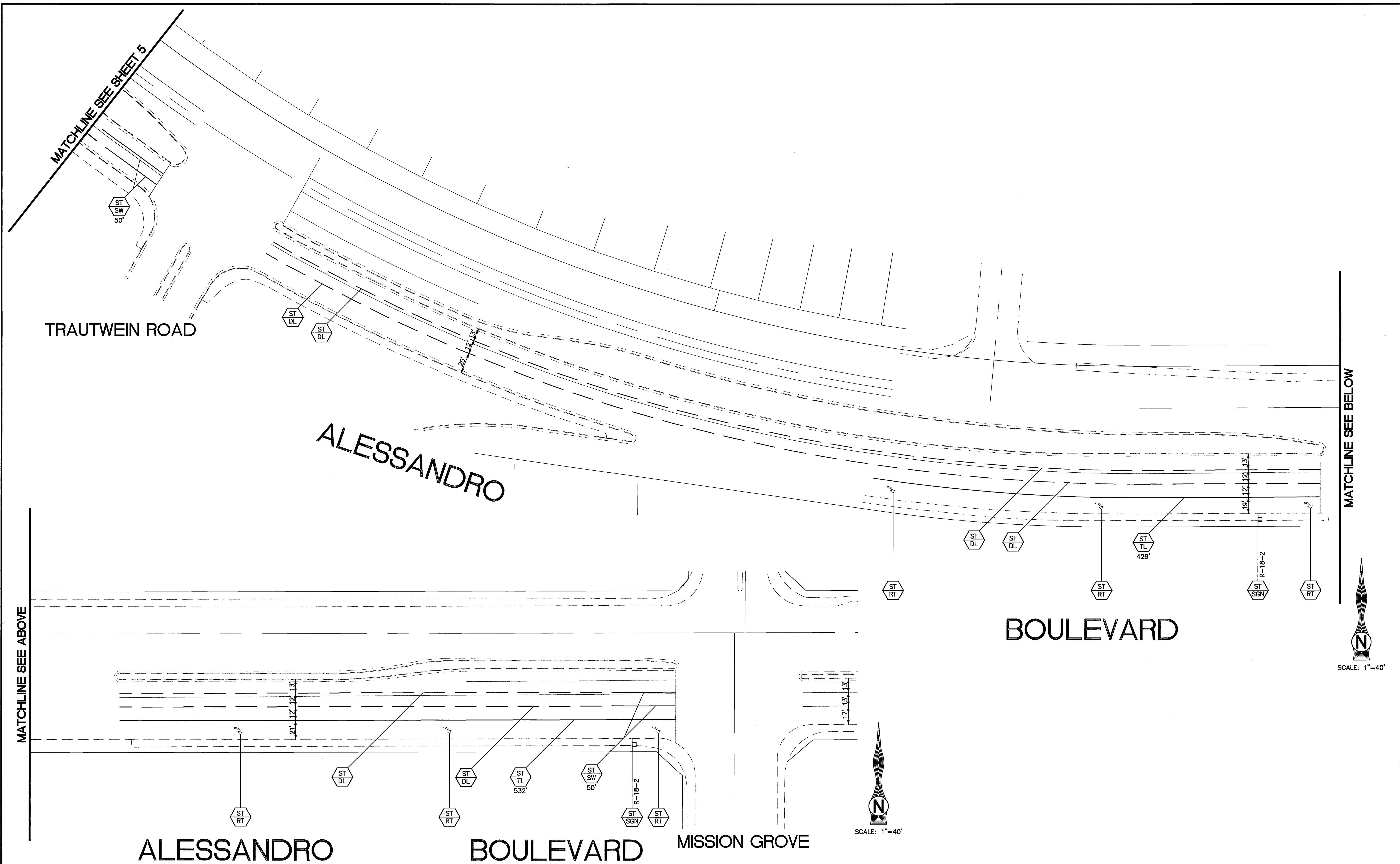

Underground Service Alert
 SECTION 4216/4217 OF THE GOVERNMENT CODE REQUIRES A DIG ALERT IDENTIFICATION NUMBER BE ISSUED BEFORE A PERMIT TO EXCAVATE WILL BE VALID
 FOR YOUR DIG ALERT I.D. NUMBER CALL UNDERGROUND SERVICE ALERT
 TOLL FREE 1-800-227-2600
 TWO WORKING DAYS BEFORE YOU DIG

TKE ENGINEERING
 TKE ENGINEERING, INC.
 4446 CENTRAL AVENUE
 RIVERSIDE, CA 92506
 (951) 680-0440
 FAX (951) 680-0490

Michael P. Thornton 4/18/06
 MICHAEL PATRICK THORNTON R.C.E. No. 44226
 EXPIRES: 6-30-07

REGISTERED PROFESSIONAL ENGINEER
 MICHAEL P. THORNTON
 No. 44226
 Exp. 6-30-07
 CIVIL
 STATE OF CALIFORNIA

DESIGNED BY: *TMR* DRAWN BY: *CAB* CHECKED BY: *MPT*

CITY OF RIVERSIDE, CALIFORNIA PUBLIC WORKS DEPARTMENT	
APPROVED BY:	DATE:
PRINCIPAL ENGINEER	4/18/06
CONST. CONTRACT ADMIN.	
STRIPING SERVICES	
SUPERVISOR	
TRAFFIC DIVISION	
DATE:	4/18/06

STRIPING AND SIGNING IMPROVEMENT PLANS
 ALESSANDRO BOULEVARD
 ARLINGTON AVENUE/TRAUTWEIN ROAD

HORIZ. SCALE: 1" = 40' VERT. SCALE: N/A

ACCT. NO.
XL-509
 SHEET 6 OF 6