

SIGNING AND STRIPING PLAN FOR: CENTRAL AVENUE PM 35165

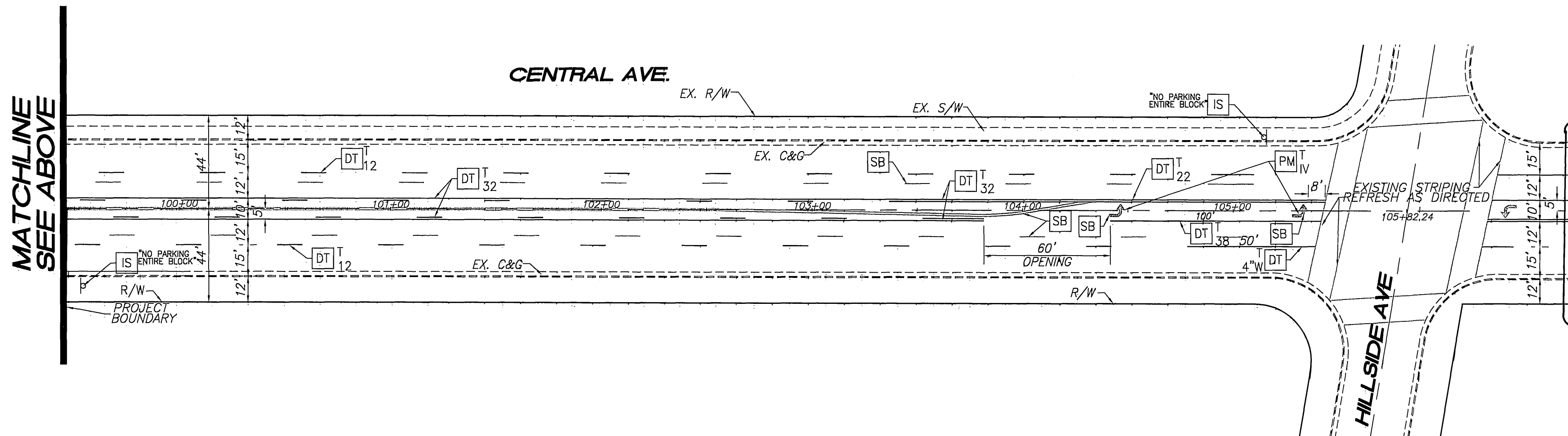
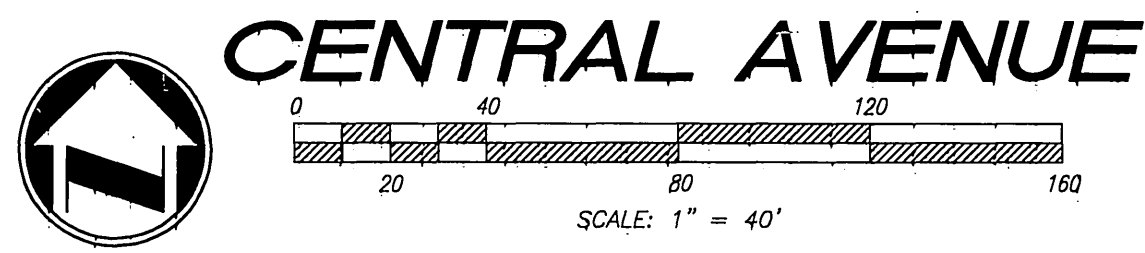
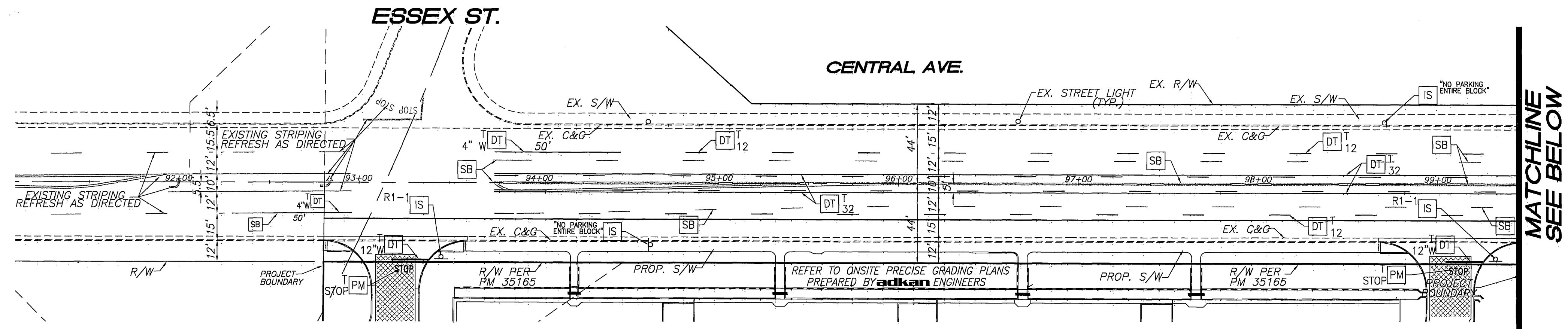

CONTRACTOR SHALL MAKE NECESSARY STRIPING MODIFICATIONS IF ANY TO PROVIDE PROPER LANE TRANSITIONS ACROSS THE INTERSECTION

LEGEND

- IS R1 SIGN CODE
INSTALL SIGN ON 2"x2" STL TUBE POLES (DIMPLED/NON-PUNCHED) PER CITY.
- PM P TYPE OF TRAFFIC STRIPING MATERIAL
= THERMOPLASTIC * P=PAINT (2 COATS)
INSTALL PAVEMENT MARKING (AS SHOWN) PER PAGES A24A THRU A24E OF THE CALTRANS STANDARD PLANS
- PM IV CALTRANS DETAIL NUMBER
- DT P TYPE OF TRAFFIC STRIPING MATERIAL
= THERMOPLASTIC * P=PAINT (2 COATS)
INSTALL TRAFFIC STRIPING AND RAISED PAVEMENT MARKERS PER CALTRANS STANDARD PLANS
- DT 22 CALTRANS DETAIL NUMBER
- SB REMOVE BY WET SANDBLASTING, ALL CONFLICTING STRIPING, PAVEMENT LEGEND AND RAISED MARKERS.
- † PROPOSED SIGN AND POST
- D PROPOSED SIGN AND EXISTING STREETLIGHT
- R/W RIGHT OF WAY
- S/W SIDE WALK
- EP EDGE OF PAVEMENT
- C&G CURB AND GUTTER

SIGNING AND STRIPING GENERAL NOTES:

1. SIGNING AND STRIPING INSTALLATION SHALL CONFORM TO THE CALIFORNIA MANUAL ON UNIFORM TRAFFIC CONTROL DEVICES (CA MUTCD), THE STATE OF CALIFORNIA DEPARTMENT OF TRANSPORTATION (CALTRANS) STANDARD PLANS AND SPECIFICATION MOST RECENT EDITIONS AND ALL ADDENDUMS THERETO, AND THE CITY OF RIVERSIDE PUBLIC WORKS DEPARTMENT STANDARD DRAWINGS, CURRENT EDITION.
2. ALL STRIPING, MARKINGS, AND LEGENDS SHALL BE REFLECTORIZED THERMOPLASTIC UNLESS OTHERWISE NOTED. THE CONTRACTOR SHALL PROVIDE AND INSTALL RAISED PAVEMENT MARKERS FOR ALL STRIPING, STRIPING, MARKINGS AND LEGENDS SHALL CONFORM TO THE LATEST CALTRANS STANDARD PLANS A20D THRU A200 AND A24A THRU A4E.
3. PRIOR TO FINAL ACCEPTANCE OF STREET IMPROVEMENTS, ALL PAVEMENT STRIPING AND STENCILING WITHIN THE PERIMETER OF THE CONSTRUCTION AREA SHALL BE RESTORED TO LIKE NEW CONDITION, IN A MANNER MEETING THE APPROVAL OF THE CITY OF RIVERSIDE.
4. THE CONTRACTOR SHALL RESTRIPE EXISTING STRIPING AND CURB MARKINGS OBLITERATED BY NEW CONSTRUCTION, WHETHER OR NOT SHOWN ON THE PLANS FOR REPLACEMENT, AT NO COST TO THE CITY.
5. AT LOCATIONS WHERE EXISTING PAINTED CURB IS TO BE RECONSTRUCTED, THE CONTRACTOR SHALL PAINT THE NEW CURB AS SHOWN ON THE PLANS WITHIN 10 WORKING DAYS OF CURB CONSTRUCTION OR AS DIRECTED BY ENGINEER. THE PAINT SHALL BE WATER-BASED WITH 2-YEAR GUARANTEE AGAINST COLOR FADING. PRIOR TO THE START OF CONSTRUCTION, THE CONTRACTOR SHALL SUBMIT TO THE CITY WRITTEN PROOF OF THE MANUFACTURER'S 2-YEAR GUARANTEE.

SIGNING AND STRIPING GENERAL NOTES (CONT'D):

6. ALL NEW STRIPING SHALL BE "CAT TRACKED" AND APPROVED BY THE ENGINEER PRIOR TO FINAL INSTALLATION. THE CONTRACTOR SHALL NOTIFY THE ENGINEER AFTER COMPLETING LAYOUT AND AT LEAST 3 WORKING DAYS BEFORE COMMENCING INSTALLATION OF STRIPING, MARKINGS AND MARKERS.
7. TRAFFIC SIGN FACE REFLECTIVE SHEETING SHALL BE 3M "ASTM TYPE 11" OR APPROVED EQUAL WITH PROTECTIVE GRAFFITI OVERLAY FILM OR AS OTHERWISE NOTED ALL WARNING SIGNS SHALL HAVE A FLUORESCENT YELLOW BACKGROUND AND SCHOOL SIGNS NOTED SHALL HAVE A FLUORESCENT YELLOW-GREEN BACKGROUND.
8. SIGNS SHALL BE STANDARD SIZE UNLESS NOTED OTHERWISE. PRIOR TO INSTALLATION, NEW SIGNS SHALL BE APPROVED BY THE CITY OF RIVERSIDE. EXACT LOCATIONS OF SIGNS SHALL BE DETERMINED BY THE CITY ENGINEER.
9. SALVAGED SIGNS AND SIGN POSTS SHALL BE DELIVERED TO THE CITY OF RIVERSIDE SIGN DEPARTMENT.
10. STRIPING SHALL BE APPLIED WITHIN 48 HOURS OF SURFACE COURSE REPLACEMENT ON STREETS OPEN TO THE PUBLIC. IN NO CASE SHALL A NEWLY PAVED STREET OPEN TO THE PUBLIC BE LEFT UNSTRIPED OVER A WEEKEND OR HOLIDAY.
11. CONTRACTOR SHALL INSTALL NEW SIGN(S) AND/OR POST(S) PER CITY OF RIVERSIDE STANDARD DRAWING No. 666.
12. ALL CONFLICTING STRIPING, PAVEMENT MARKINGS, LEGENDS AND RAISED PAVEMENT MARKERS SHALL BE REMOVED EVEN IF NOT SHOWN ON PLANS. REMOVALS OF STRIPING, PAVEMENT MARKINGS AND LEGENDS SHALL BE DONE BY WET SAND BLASTING AND/OR GRINDING, BLACK OUT IS NOT PERMITTED. ALL DAMAGED PAVEMENT DUE TO REMOVALS SHALL BE REPAIRED AS NECESSARY TO MAINTAIN A SMOOTH AND UNIFORM SURFACE OR AS DIRECTED BY THE ENGINEER.

THOMAS BROS. GUIDE PAGE 745,
GRID A-1, 2006 EDITION

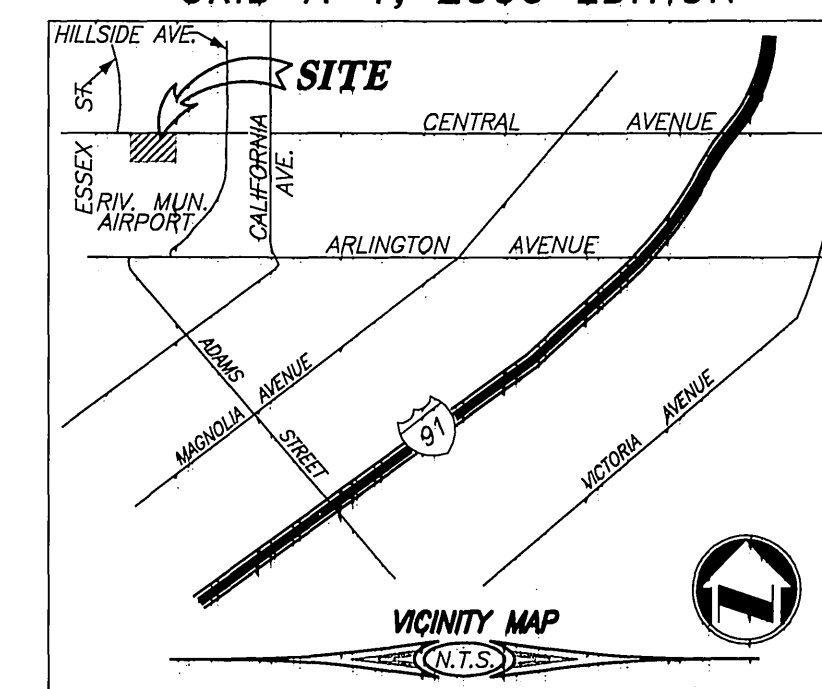

SEC. 32 T. 2S. R. 5W



Underground Service Alert
Call: TOLL FREE
1-800-227-2600
TWO WORKING DAYS BEFORE YOU DIG

CITY OF RIVERSIDE BUSINESS TAX ACCT. #058833 EXP. 1/1/08

PLANS PREPARED BY:
adkan ENGINEERS
Civil Engineering - Surveying - Planning
6820 Airport Drive, Riverside, CA 92504
Tel: (951) 588-7044 Fax: (951) 588-0599

BENCHMARK: H3-G3
CITY OF RIVERSIDE
CHISEL SQUARE IN THE TOP OF CURB AT THE B.C.R. OF THE N.W. CORNER OF ACORN STREET AND CENTRAL AVENUE.
ELEVATION: 747.059

| MARK | REVISIONS | APPR. | DATE |
|------|-----------|-------|------|
| | | | |
| | | | |

CITY OF RIVERSIDE PUBLIC WORKS DEPARTMENT
APPROVED BY: *[Signature]* DATE: 10/24/07
PRINCIPAL ENGINEER: *[Signature]* DATE: 10/24/07
TRAFFIC DIVISION: *[Signature]* DATE: 10/24/07
CITY ENGINEER

SIGNING & STRIPING PLAN
CENTRAL AVENUE
PM 35165
CENTRAL AVENUE BETWEEN ESSEX ST. AND HILLSIDE AVE.
STA 92+80.26 - 99+46.05
APN. 190-210-009

PW ACCOUNT NO.
XL-558
SHEET **1** OF **1**
J.N. 7049